

Abbywood 2359 : Details

Style	Craftsman/Victorian
Exterior Material	Siding
Bedrooms	3
Bathrooms	2 / 1
Total Living Sq Ft	2,359
Total Covered Sq Ft	3,068
Dimensions (w x d x h)	77' 0" x 21' 0" x 32' 0"

AS LOW AS \$250
FULLY CUSTOMIZABLE &
PROFESSIONALLY DESIGNED

	First Floor	Other Floors	Other Features	
Square Footage	923	1,436	Cov'd. Front Porch	Cov'd. Side Porch
Master Bedroom		X	Ext. Balcony	Foyer
Living Room	X		Loft	Portico
Garage(s)	2 car, Front Load, Straight In			
Stairs	Standard (2 flights)			

Abbywood 2359 : Front Elevation



Abbywood 2359 : Floor 1

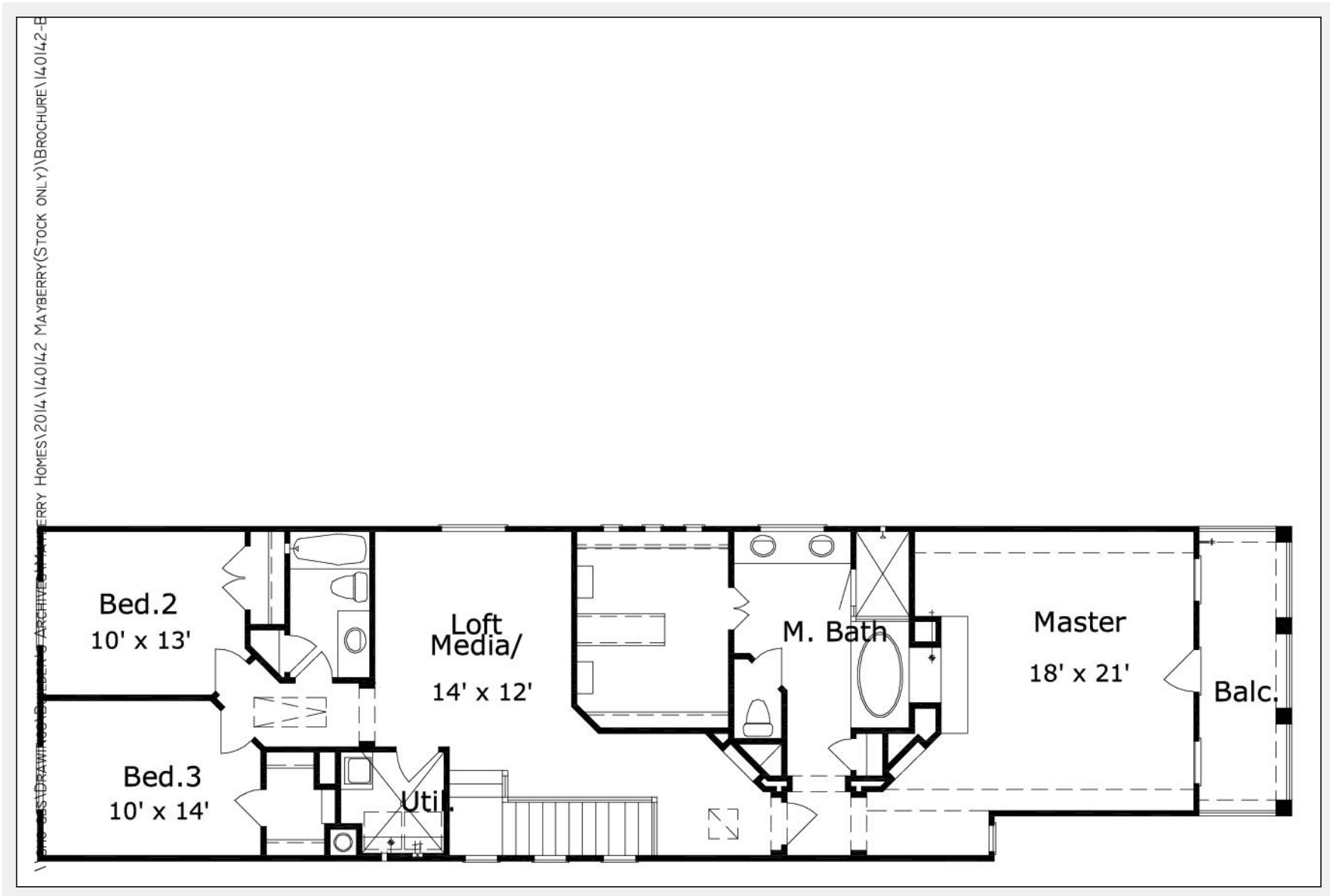

Abbywood 2359 : Floor 2

