

Houghton 3298 : Details

AS LOW AS \$250
FULLY CUSTOMIZABLE &
PROFESSIONALLY DESIGNED

Style	Craftsman
Exterior Material	Brick & Siding
Bedrooms	4
Bathrooms	3 / 1
Total Living Sq Ft	3,298
Total Covered Sq Ft	4,722
Dimensions (w x d x h)	61' 10" x 82' 6" x 31' 6"

	First Floor	Other Floors	Other Features	
Square Footage	2,104	1,194	Bar	Breezeway
Master Bedroom	X		Cov'd. Pavilion	Foyer
Dining Room	X		Home Office	Mud Room
Living Room	X		Outdoor Kitchen	
Family Room	X			
Game Room		X		
Study	X			
Guest Room		X		

Garage(s) 2 car, Front Load, Detached
Stairs

Houghton 3298 : Front Elevation



Houghton 3298 : Floor 1

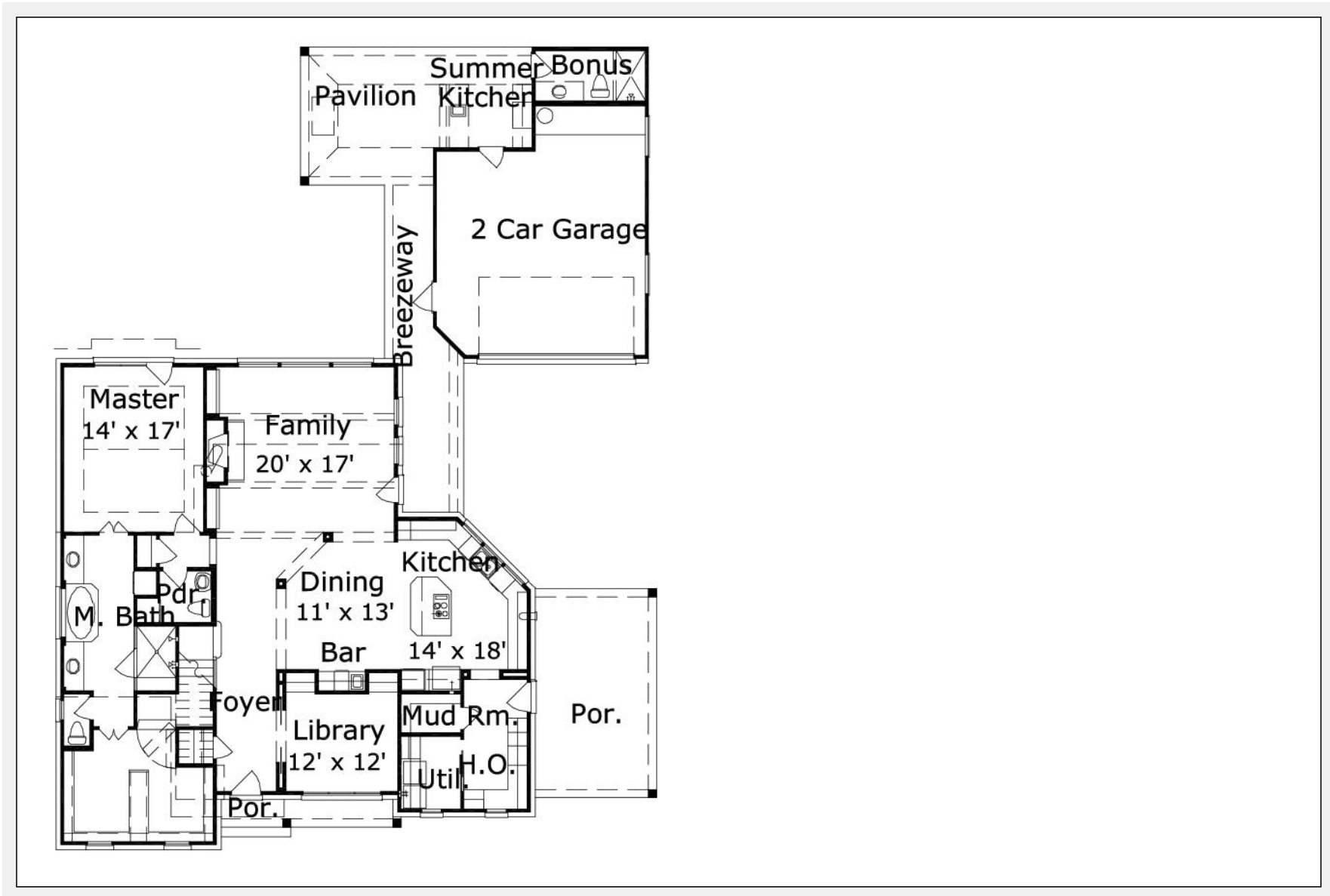

Houghton 3298 : Floor 2

