

## Lysanda 5720 : Details

**AS LOW AS \$250**  
**FULLY CUSTOMIZABLE &**  
**PROFESSIONALLY DESIGNED**

<b>Style</b>	Ranch
<b>Exterior Material</b>	Brick
<b>Bedrooms</b>	4
<b>Bathrooms</b>	5 / 1
<b>Total Living Sq Ft</b>	5,720
<b>Total Covered Sq Ft</b>	7,777
<b>Dimensions (w x d x h)</b>	79' 8" x 122' 2" x 34' 11"

	First Floor	Other Floors	Other Features	
<b>Square Footage</b>	4,024	1,696	Bar	Butler Pantry
<b>Master Bedroom</b>	X		Cov'd. Pavilion	Foyer
<b>Dining Room</b>	X		Home Office	Int. Balcony
<b>Living Room</b>	X		Outdoor Fireplace	Outdoor Kitchen
<b>Family Room</b>	X		Wine Room	
<b>Game Room</b>		X		
<b>Study</b>	X			
<b>Guest Room</b>		X		

**Garage(s)** 3 car, Front Load, Swing (Side Facing)  
**Stairs** Standard

## Lysanda 5720 : Front Elevation



# Lysanda 5720 : Floor 1

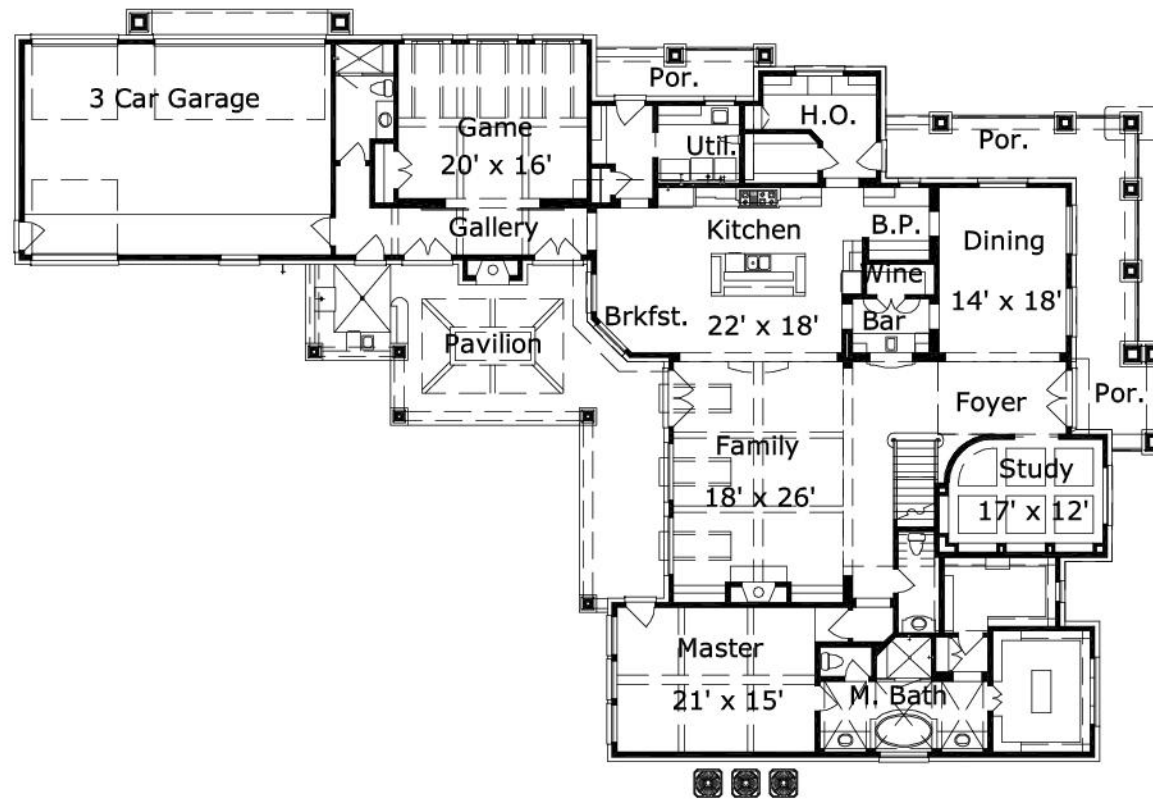

## Lysanda 5720 : Floor 2

