

Ladin 7034 : Details

AS LOW AS \$250
FULLY CUSTOMIZABLE &
PROFESSIONALLY DESIGNED

Style	Tuscan
Exterior Material	Stone & Stucco
Bedrooms	5
Bathrooms	5 / 3
Total Living Sq Ft	7,034
Total Covered Sq Ft	9,590
Dimensions (w x d x h)	116' 10" x 86' 4" x 33' 4"

	First Floor	Other Floors	Other Features	
Square Footage	4,746	2,288	Bar	Butler Pantry
Master Bedroom	X		Cabana Bath	Cov'd. Pavilion
Dining Room	X		Foyer	Gallery
Living Room	X		Home Office	Outdoor Fireplace
Family Room	X		Outdoor Kitchen	Terrace
Study	X		Wine Room	
Guest Room	X			
Home Theater		X		

Garage(s) 4 car, Front Load, Split
Stairs Spiral

Ladin 7034 : Front Elevation



Ladin 7034 : Floor 1

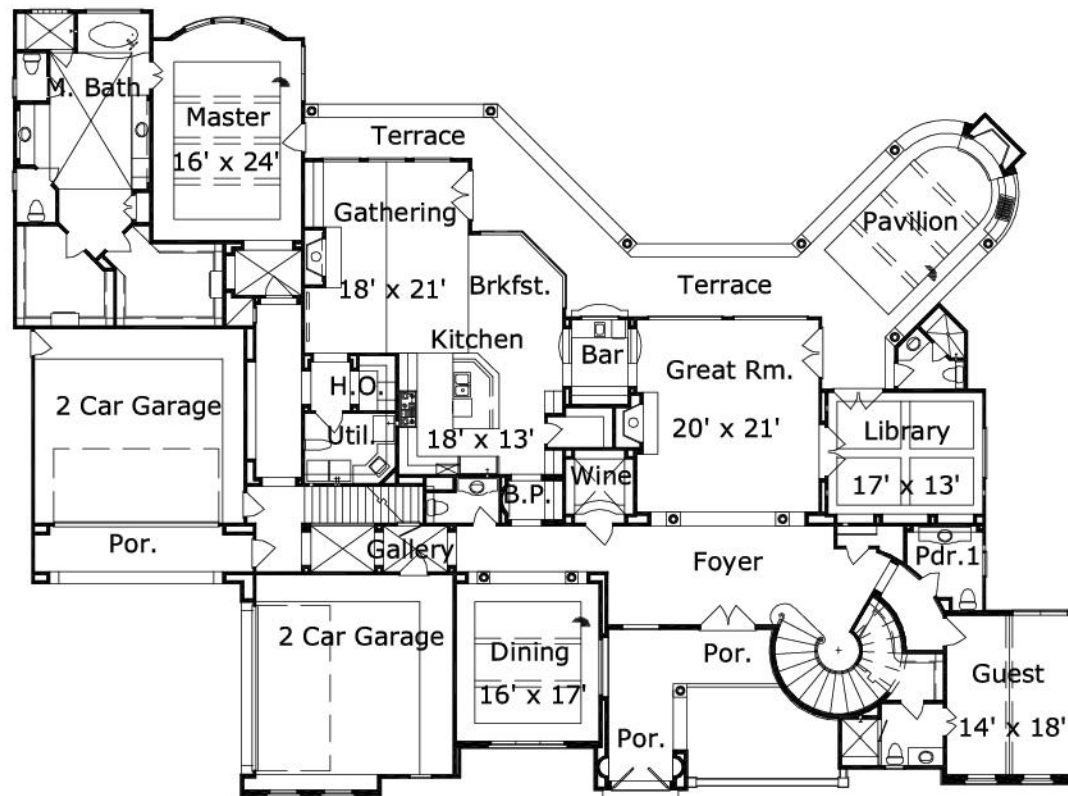

Ladin 7034 : Floor 2

