

Boadley 3765: Details

Style	Mediterranean
Exterior Materials	Stucco & Cultured Stone
Bedrooms	4
Bathrooms	3 / 1
Total Living Sq Ft	3,765
Total Covered Sq Ft	4,436
Dimensions (w x d x h)	45'6" x 66'0" x 32'11"

AS LOW AS \$250
FULLY CUSTOMIZABLE &
PROFESSIONALLY DESIGNED

	First Floor	Other Floors	Other Features
Square Footage	2,231	1,534	Bar
Bedrooms	1	3	Cov'd. Front Porch
Ceiling Heights	10'0"	9'0"	Cov'd. Rear Porch
Master Bedroom	X		Foyer
Dining Room	X		Int. Balcony
Living Room	X		Lanai
Family Room	X		
Game Room		X	
Study	X		
Guest Room		X	

Garage(s)	Front Load Straight In
Stairs	Standard

Boadley 3765: Front Elevation



Boadley 3765: Floor 1

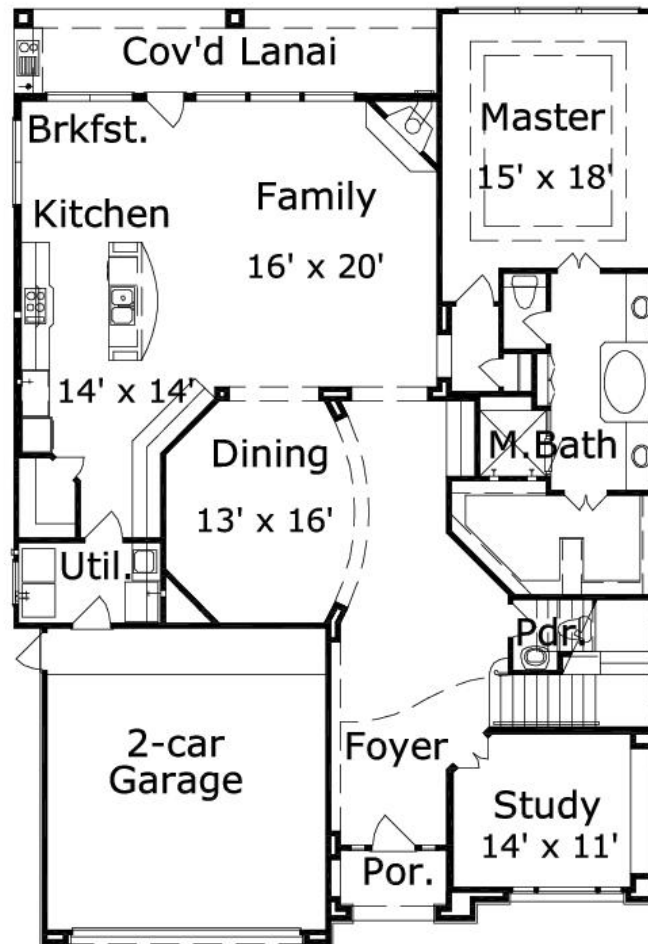

Boadley 3765: Floor 2

