

## Fleming 7857: Details

Style	Mediterranean
Exterior Materials	Stucco
Bedrooms	6
Bathrooms	6 / 2
Total Living Sq Ft	7,857
Total Covered Sq Ft	10,441
Dimensions (w x d x h)	86'8" x 108'10" x 35'5"

**AS LOW AS \$250**  
**FULLY CUSTOMIZABLE &**  
**PROFESSIONALLY DESIGNED**

	First Floor	Other Floors	Other Features	
Square Footage	4,822	3,034	Bar	Int. Balcony
Bedrooms	2	4	Butler Pantry	Outdoor Fireplace
Ceiling Heights	11'0"	10'0"	Computer Alcove	Outdoor Kitchen
Master Bedroom	X		Cov'd. Pavilion	Playroom
Dining Room	X		Cov'd. Terrace	Quarters
Living Room	X		Foyer	Theater/Media
Family Room	X		Gallery	Wine Room
Game Room		X	Hidden Room	
Study	X		Home Office	
Guest Room	X			
Home Theater		X		
Garage(s)	Front Load Swing (Side Facing)			
Stairs	Standard (2 flights)			

## Fleming 7857: Front Elevation



## Fleming 7857: Floor 1

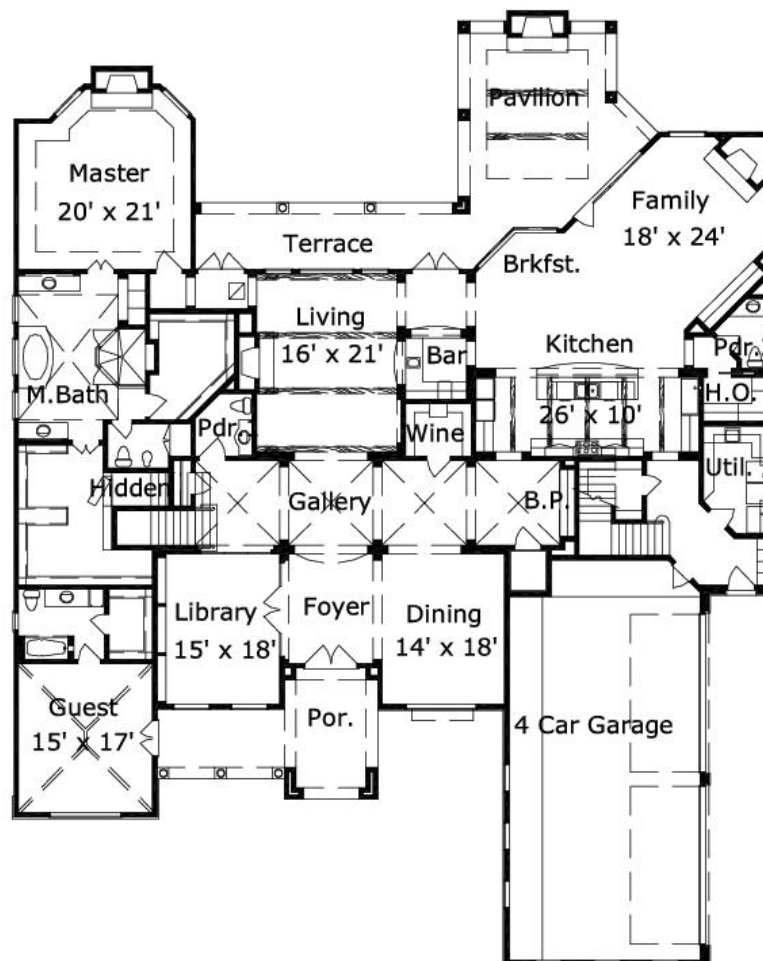

## Fleming 7857: Floor 2

