

## Longlane 2355: Details

Style	Traditional
Exterior Materials	Wood Panel
Bedrooms	3
Bathrooms	2 / 1
Total Living Sq Ft	2,355
Total Covered Sq Ft	2,977
Dimensions (w x d x h)	18'6" x 118'0" x 29'10"

**AS LOW AS \$250**  
**FULLY CUSTOMIZABLE &**  
**PROFESSIONALLY DESIGNED**

	First Floor	Other Floors	Other Features
Square Footage	1,157	1,198	Courtyard
Bedrooms	0	3	Foyer
Ceiling Heights	10'0"	9'0"	
Master Bedroom		X	
Dining Room	X		
Living Room	X		
Family Room	X		
Guest Room		X	
Garage(s)	Rear Load Swing (Entry Facing)		
Stairs	Standard		

## Longlane 2355: Front Elevation



## Longlane 2355: Floor 1

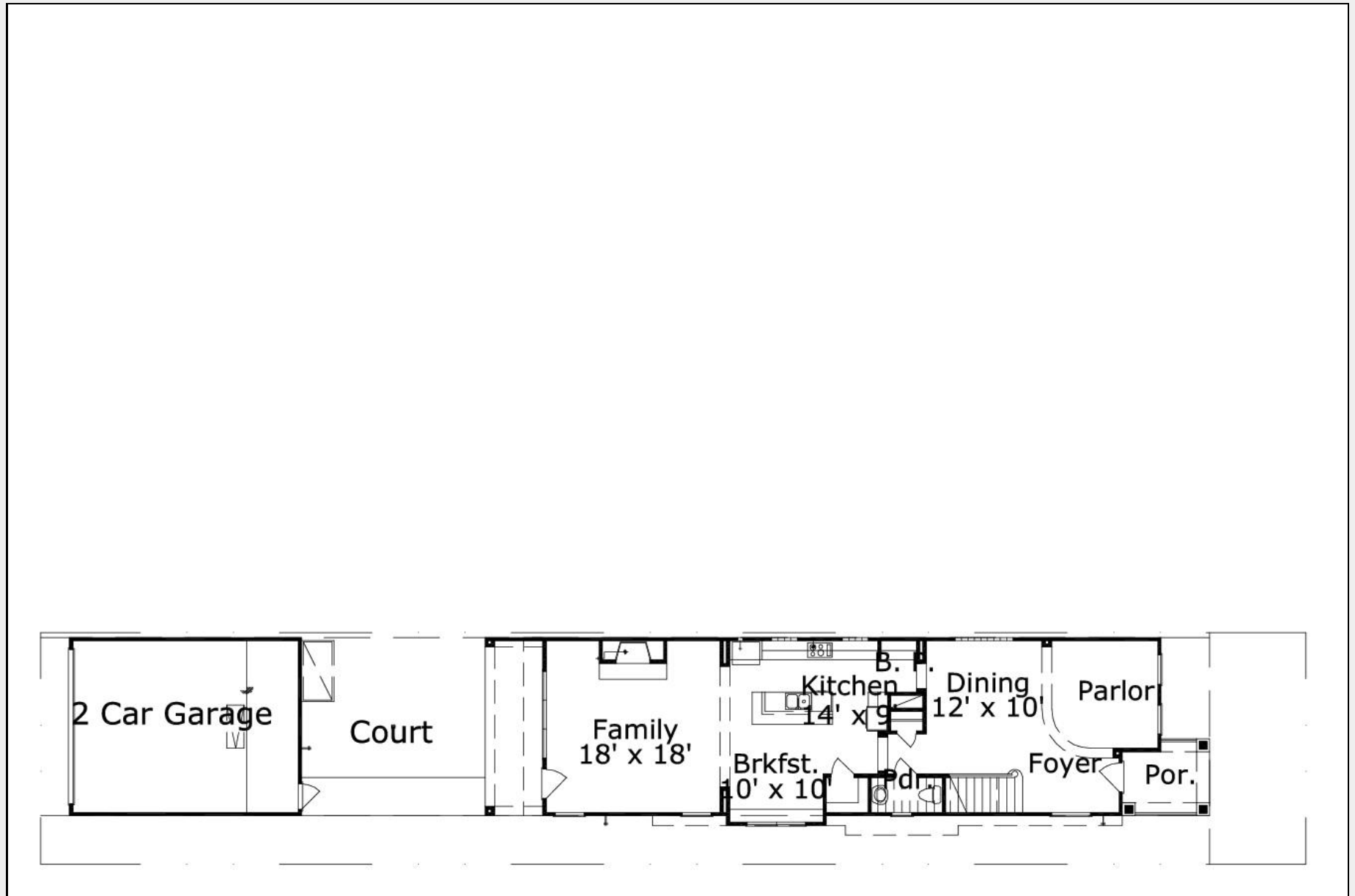

Longlane 2355: Floor 2

