

Courtridge 4224: Details

AS LOW AS \$250
FULLY CUSTOMIZABLE &
PROFESSIONALLY DESIGNED

Style	French
Exterior Materials	Brick
Bedrooms	4
Bathrooms	3 / 1
Total Living Sq Ft	4,224
Total Covered Sq Ft	5,274
Dimensions (w x d x h)	64'10" x 69'4" x 38'7"

	First Floor	Other Floors	Other Features
Square Footage	2,649	1,575	Bonus Room
Bedrooms	1	3	Butler Pantry
Ceiling Heights	10'0"	9'0"	Computer Alcove
Master Bedroom	X		Corner Lot
Dining Room	X		Covered Front Porch
Living Room	X		
Family Room	X		
Game Room		X	
Study	X		
Guest Room		X	

Garage(s)	Front Load Swing (Side Facing)
Stairs	Split

Notes

The second floor bonus room, 301 sq. ft., is not included in the living area of this plan.

Courtridge 4224: Front Elevation



Courtridge 4224: Floor 1

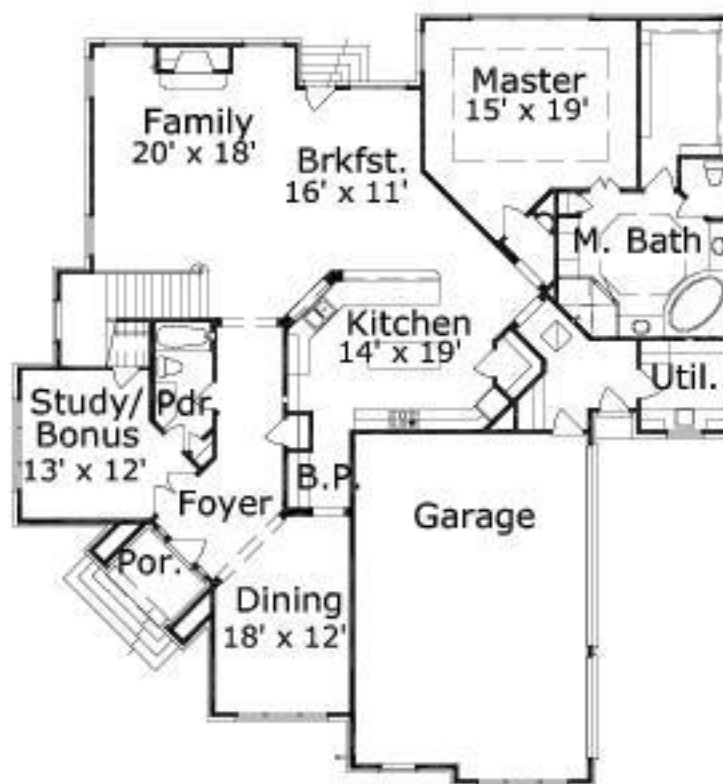

Courtridge 4224: Floor 2

