

## Roswell 4009.2: Details

**AS LOW AS \$250**  
**FULLY CUSTOMIZABLE &**  
**PROFESSIONALLY DESIGNED**

<b>Style</b>	French
<b>Exterior Materials</b>	Brick and Stone
<b>Bedrooms</b>	4
<b>Bathrooms</b>	3 / 1
<b>Total Living Sq Ft</b>	4,009
<b>Total Covered Sq Ft</b>	4,960
<b>Dimensions (w x d x h)</b>	69'8" x 71'10" x 34'9"

	First Floor	Other Floors	Other Features
<b>Square Footage</b>	2,272	1,737	Covered Front Porch
<b>Bedrooms</b>	1	3	Foyer
<b>Ceiling Heights</b>	9'0"	9'0"	Interior Balcony
<b>Master Bedroom</b>	X		Motor Court
<b>Dining Room</b>	X		Theater/Media
<b>Living Room</b>	X		Two Story Family Room
<b>Family Room</b>	X		
<b>Game Room</b>		X	
<b>Guest Room</b>		X	
<b>Home Theater</b>		X	

<b>Garage(s)</b>	Front Load Split
<b>Stairs</b>	Curved

## Roswell 4009.2: Front Elevation



## Roswell 4009.2: Floor 1

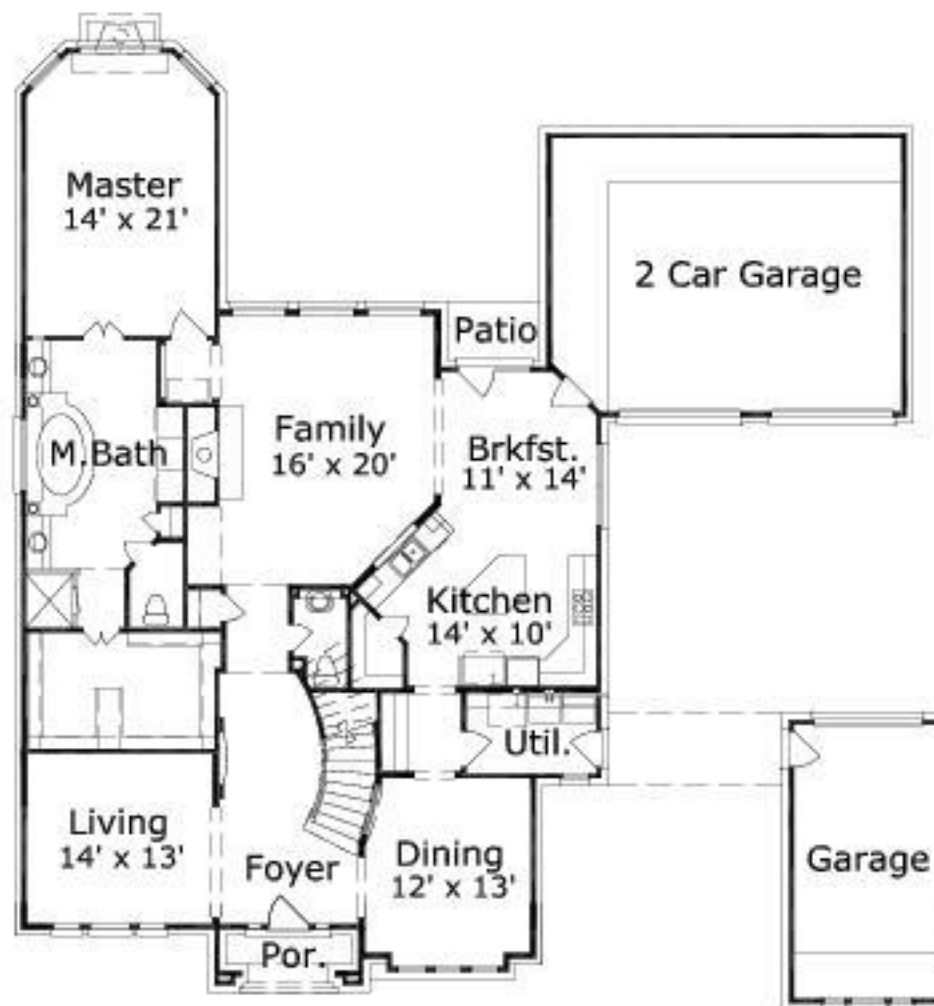

## Roswell 4009.2: Floor 2

