

## Harville 5330 : Details

<b>Style</b>	French
<b>Exterior Material</b>	Brick and Stone
<b>Bedrooms</b>	4
<b>Bathrooms</b>	4 / 2
<b>Total Living Sq Ft</b>	5,330
<b>Total Covered Sq Ft</b>	8,334
<b>Dimensions (w x d x h)</b>	103' 8" x 115' 2" x 32' 11"

**AS LOW AS \$250**  
**FULLY CUSTOMIZABLE &**  
**PROFESSIONALLY DESIGNED**

	First Floor	Other Floors	Other Features	
<b>Square Footage</b>	4,804	526	Bar	Bonus Room
<b>Master Bedroom</b>	X		Butler Pantry	Coffee/Juice Bar
<b>Dining Room</b>	X		Cov'd. Front Porch	Cov'd. Pavilion
<b>Living Room</b>	X		Cov'd. Rear Porch	Cov'd. Side Porch
<b>Family Room</b>	X		Foyer	Gallery
<b>Game Room</b>	X		Kitchenette	Outdoor Fireplace
<b>Study</b>	X		Outdoor Kitchen	Unfinished Storage
<b>Guest Room</b>		X		

**Garage(s)** 3 car, Side Load, Swing (Side Facing)  
**Stairs** Reverse

**Notes:**

The second floor bonus room & storage area is not included in the living area of this plan. These areas would be an additional 5

## Harville 5330 : Front Elevation



## Harville 5330 : Floor 1

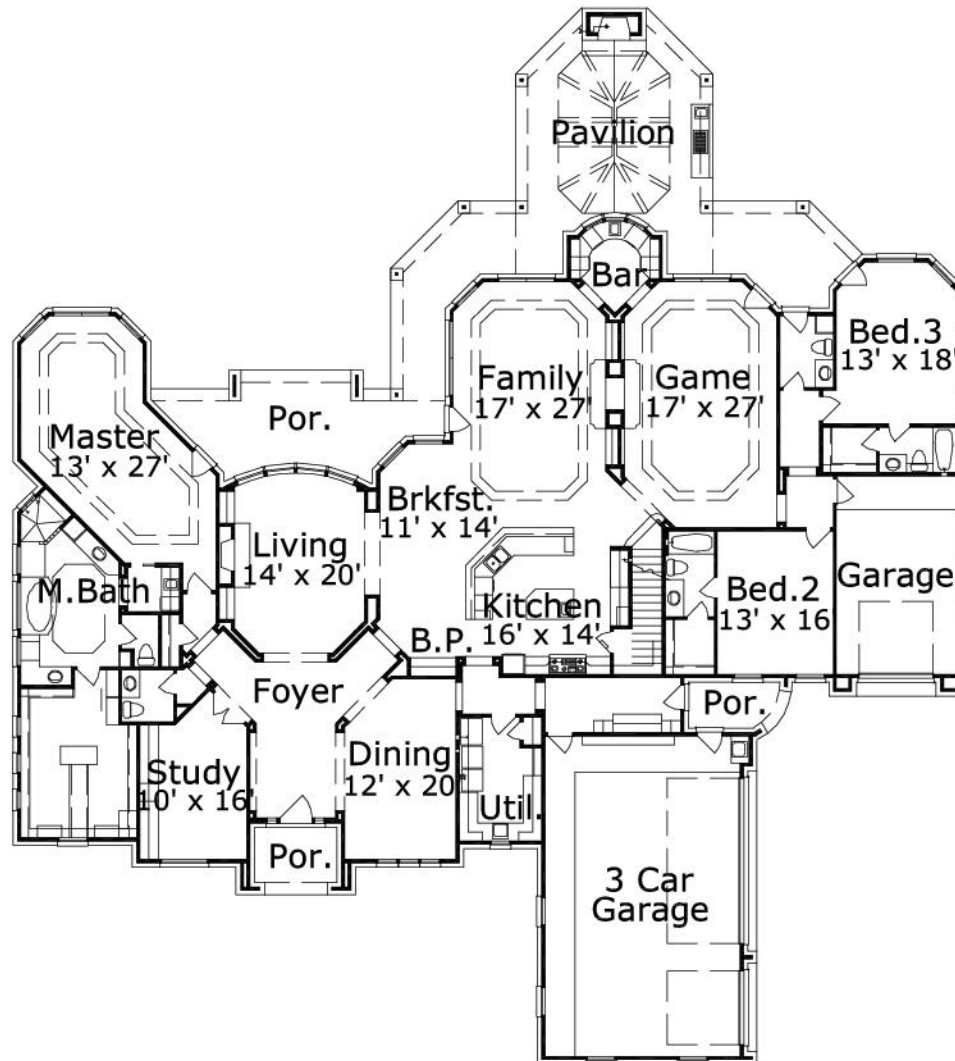

## Harville 5330 : Floor 2

