

## Dartmouth 5820: Details

**AS LOW AS \$250**  
**FULLY CUSTOMIZABLE &**  
**PROFESSIONALLY DESIGNED**

<b>Style</b>	Traditional
<b>Exterior Materials</b>	Stucco
<b>Bedrooms</b>	4
<b>Bathrooms</b>	3 / 1
<b>Total Living Sq Ft</b>	5,820
<b>Total Covered Sq Ft</b>	7,522
<b>Dimensions (w x d x h)</b>	85'6" x 85'11" x 35'6"

	First Floor	Other Floors	Other Features
<b>Square Footage</b>	3,818	2,009	Bar
<b>Bedrooms</b>	1	3	Butler Pantry
<b>Ceiling Heights</b>	10'0"	9'0"	Cedar Closet
<b>Master Bedroom</b>	X		Christmas Storage
<b>Dining Room</b>	X		Computer Alcove
<b>Living Room</b>	X		Conservatory
<b>Family Room</b>	X		Covered Rear Porch
<b>Game Room</b>		X	Exterior Balcony
<b>Guest Room</b>		X	Foyer
			Master Fireplace
			Playroom

<b>Garage(s)</b>	Front Load Swing (Entry Facing)
<b>Stairs</b>	Spiral (2 flights)

### Notes

The living area of this plan does not include the future quarters on the second floor. The additional square footage is 568 square feet.

## Dartmouth 5820: Front Elevation



## Dartmouth 5820: Floor 1

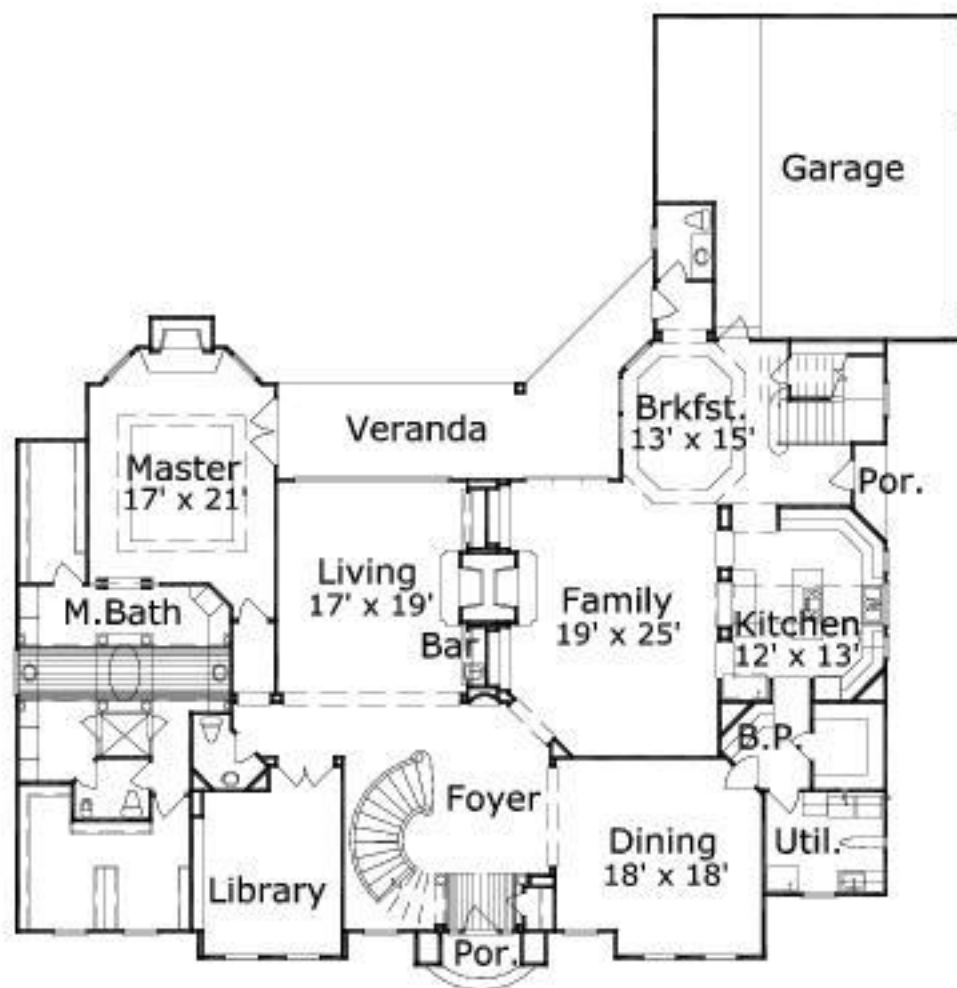

## Dartmouth 5820: Floor 2

