

## Forestdale 6355: Details

**AS LOW AS \$250**  
**FULLY CUSTOMIZABLE &**  
**PROFESSIONALLY DESIGNED**

<b>Style</b>	Colonial
<b>Exterior Materials</b>	Brick
<b>Bedrooms</b>	5
<b>Bathrooms</b>	4 / 2
<b>Total Living Sq Ft</b>	6,355
<b>Total Covered Sq Ft</b>	10,559
<b>Dimensions (w x d x h)</b>	129'6" x 66'4" x 36'0"

	First Floor	Other Floors	Other Features
<b>Square Footage</b>	3,360	2,995	Bar                      Master with Sitting Area
<b>Bedrooms</b>	1	4	Butler Pantry          Playroom
<b>Ceiling Heights</b>	10'0"	9'0"	Cabana Bath          Second Utility Room
<b>Master Bedroom</b>	X		Coffee/Juice Bar      Separate Master Closet
<b>Dining Room</b>	X		Covered Front Porch
<b>Living Room</b>	X		Covered Rear Porch
<b>Family Room</b>	X		Exercise Room
<b>Game Room</b>		X	Exterior Balcony
<b>Study</b>	X		Foyer
<b>Guest Room</b>		X	Home Office
			Interior Balcony

<b>Garage(s)</b>	Rear Load Straight In
<b>Stairs</b>	Curved (2 flights)

## Forestdale 6355: Front Elevation



## Forestdale 6355: Floor 1

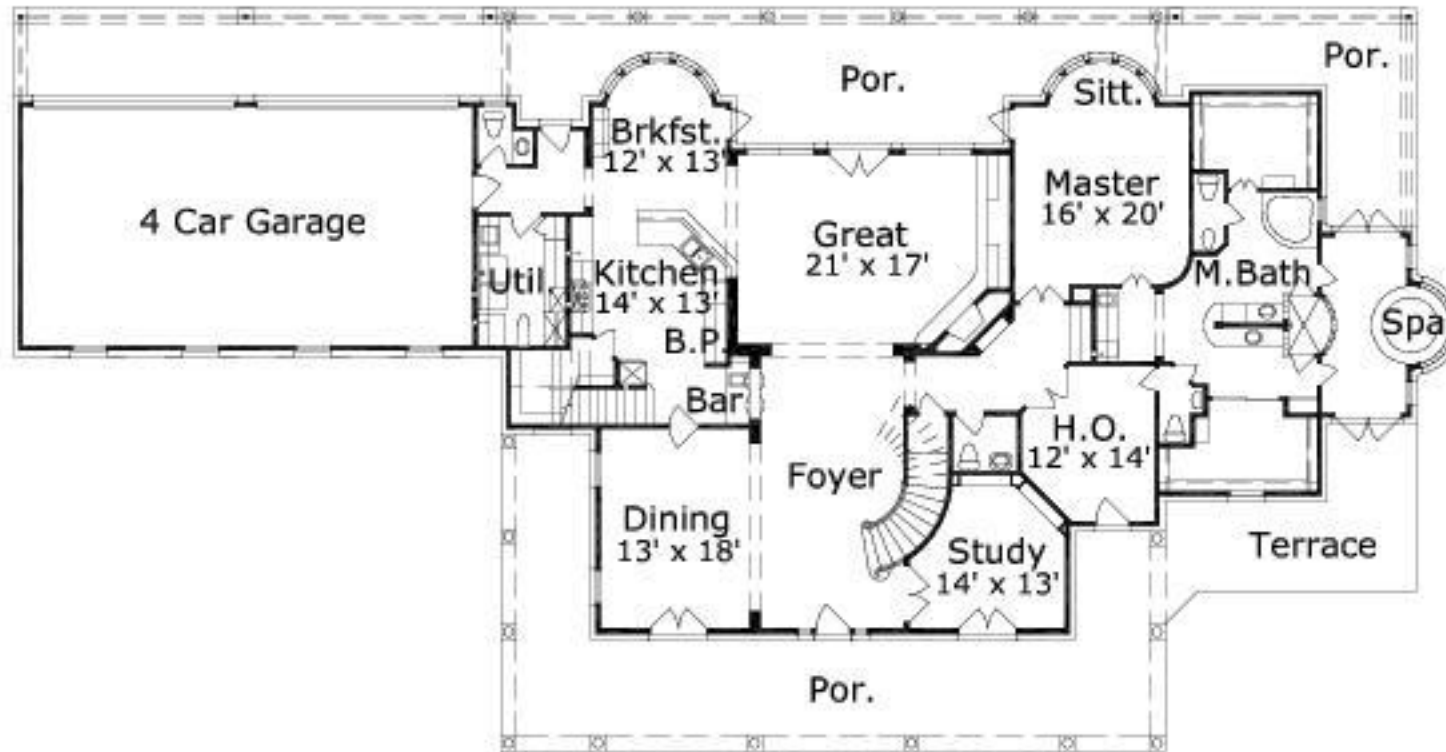

## Forestdale 6355: Floor 2

