

Dotson 5480: Details

AS LOW AS \$250
FULLY CUSTOMIZABLE &
PROFESSIONALLY DESIGNED

Style	Country French
Exterior Materials	Brick and Stone
Bedrooms	4
Bathrooms	5 / 1
Total Living Sq Ft	5,470
Total Covered Sq Ft	7,947
Dimensions (w x d x h)	121'8" x 115'4" x 32'7"

	First Floor	Other Floors	Other Features
Square Footage	3,415	2,055	Bonus Room Outdoor Fireplace
Bedrooms	1	3	Butler Pantry Outdoor Kitchen
Ceiling Heights	10'0"	9'0"	Cabana Bath Portico
Master Bedroom	X		Computer AlcoveSauna
Dining Room	X		Conservatory Separate Master Closet
Living Room	X		Covered Pavilion Terrace
Family Room	X		Covered Terrace Theater/Media
Guest Room		X	Foyer
Home Theater		X	Gallery
			His & Her Master Bath
			Interior Balcony

Garage(s)	Side Load Swing (Entry Facing)
Stairs	Curved (3 flights)

Notes

The living area of this plan does not include the first floor outdoor sauna/storage/bathroom. The additional square footage for the first floor outdoor sauna/storage/bathroom is 159 square feet.

Dotson 5480: Front Elevation



Dotson 5480: Floor 1

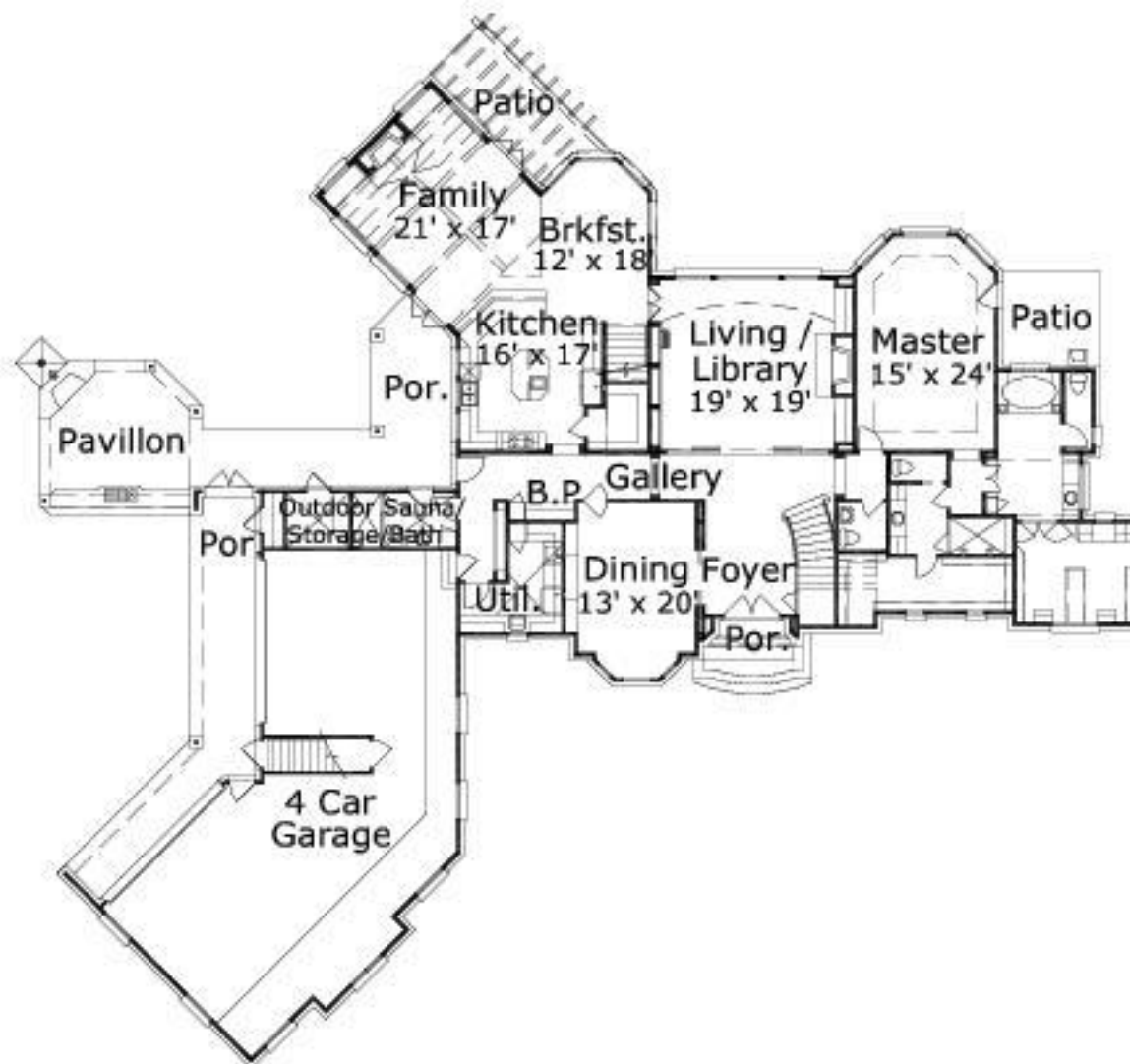

Dotson 5480: Floor 2

