

Dodson 6533: Details

AS LOW AS \$250
FULLY CUSTOMIZABLE &
PROFESSIONALLY DESIGNED

Style	Traditional
Exterior Materials	Brick
Bedrooms	5
Bathrooms	5 / 2
Total Living Sq Ft	6,533
Total Covered Sq Ft	7,621
Dimensions (w x d x h)	74'0" x 87'6" x 34'9"

	First Floor	Other Floors	Other Features
Square Footage	3,766	2,767	Bar
Bedrooms	1	4	Computer Alcove
Ceiling Heights	11'0"	9'0"	Conservatory
Master Bedroom	X		Covered Rear Porch
Dining Room	X		Foyer
Living Room	X		Gallery
Family Room	X		Interior Balcony
Game Room		X	Playroom
Study	X		Quarters
Guest Room		X	Separate Master Closet
			Wine Room

Garage(s)	Side Load Swing (Entry Facing)
Stairs	Standard (2 flights)

Dodson 6533: Front Elevation



Dodson 6533: Floor 1

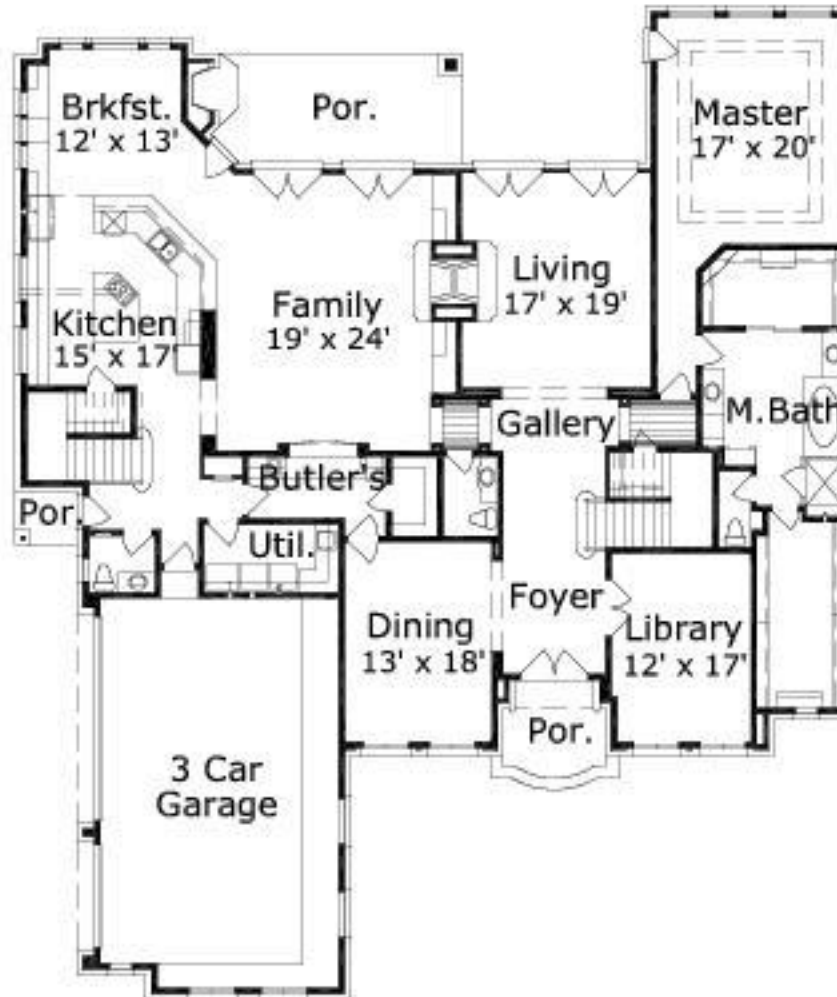

Dodson 6533: Floor 2

