

Bellgrove 4281 : Details

AS LOW AS \$250
FULLY CUSTOMIZABLE &
PROFESSIONALLY DESIGNED

Style	Traditional
Exterior Material	Brick
Bedrooms	5
Bathrooms	4 / 1
Total Living Sq Ft	4,281
Total Covered Sq Ft	5,263
Dimensions (w x d x h)	70' 0" x 62' 6" x 35' 10"

	First Floor	Other Floors	Other Features	
Square Footage	2,730	1,551	Conservatory	Foyer
Master Bedroom	X		Home Office	Int. Balcony
Dining Room	X		Playroom	Portico
Living Room	X		Sunroom	
Family Room	X			
Game Room		X		
Study	X			
Guest Room		X		

Garage(s) 3 car, Front Load, Straight In
Stairs Standard

Bellgrove 4281 : Front Elevation



Bellgrove 4281 : Floor 1

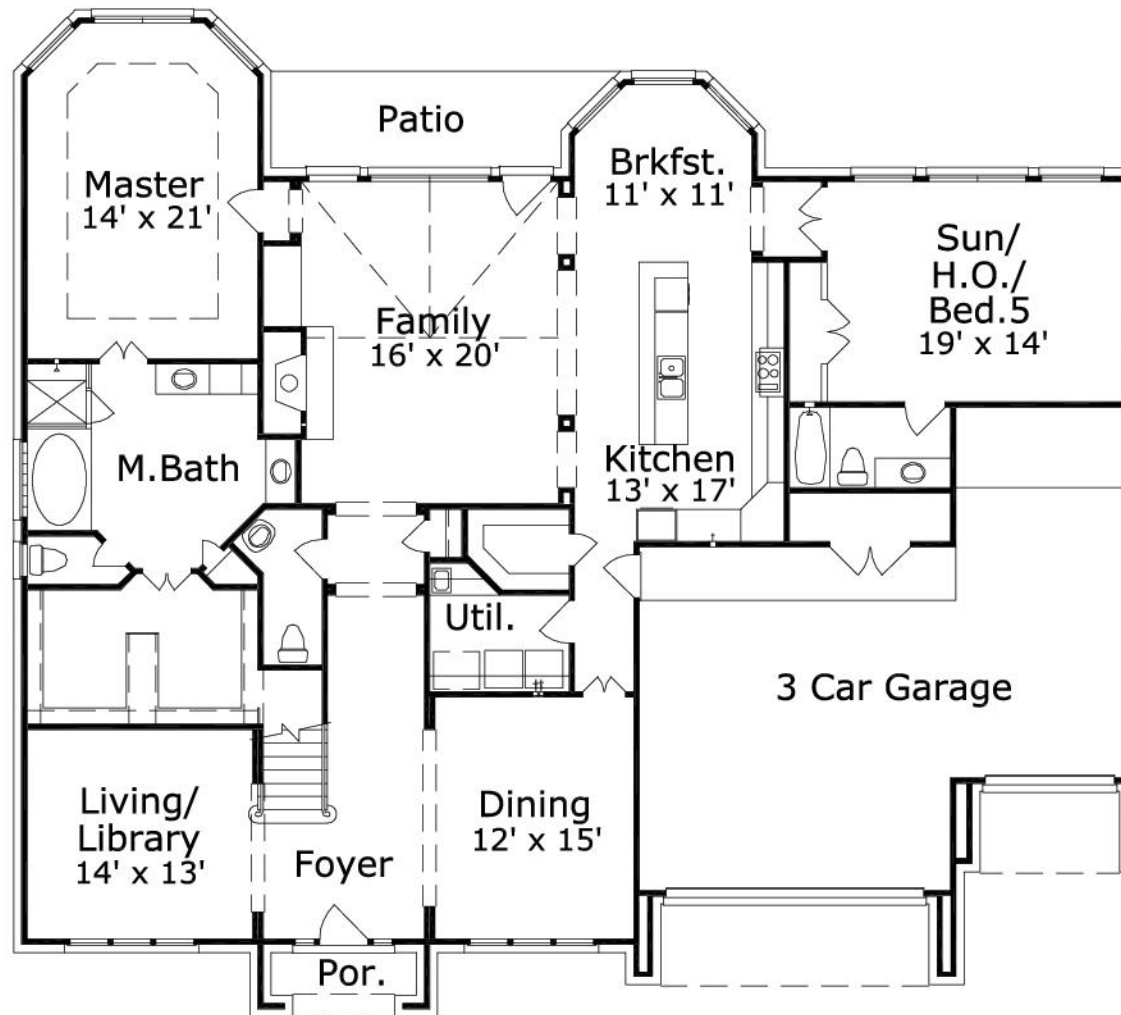

Bellgrove 4281 : Floor 2

