

Blairmore 4340: Details

AS LOW AS \$250
FULLY CUSTOMIZABLE &
PROFESSIONALLY DESIGNED

Style	Country French
Exterior Materials	Stucco & Cultured Stone
Bedrooms	4
Bathrooms	4 / 1
Total Living Sq Ft	4,340
Total Covered Sq Ft	6,096
Dimensions (w x d x h)	95'0" x 68'4" x 31'9"

	First Floor	Other Floors	Other Features
Square Footage	2,899	1,441	Butler Pantry
Bedrooms	1	3	Covered Front Porch
Ceiling Heights	10'0"	9'0"	Covered Rear Porch
Master Bedroom	X		Foyer
Dining Room	X		Interior Balcony
Living Room	X		Playroom
Family Room	X		Separate Master Closet
Game Room		X	
Study	X		
Guest Room		X	

Garage(s)	Side Load Swing (Entry Facing)
Stairs	Curved (2 flights)

Blairmore 4340: Front Elevation



Blairmore 4340: Floor 1

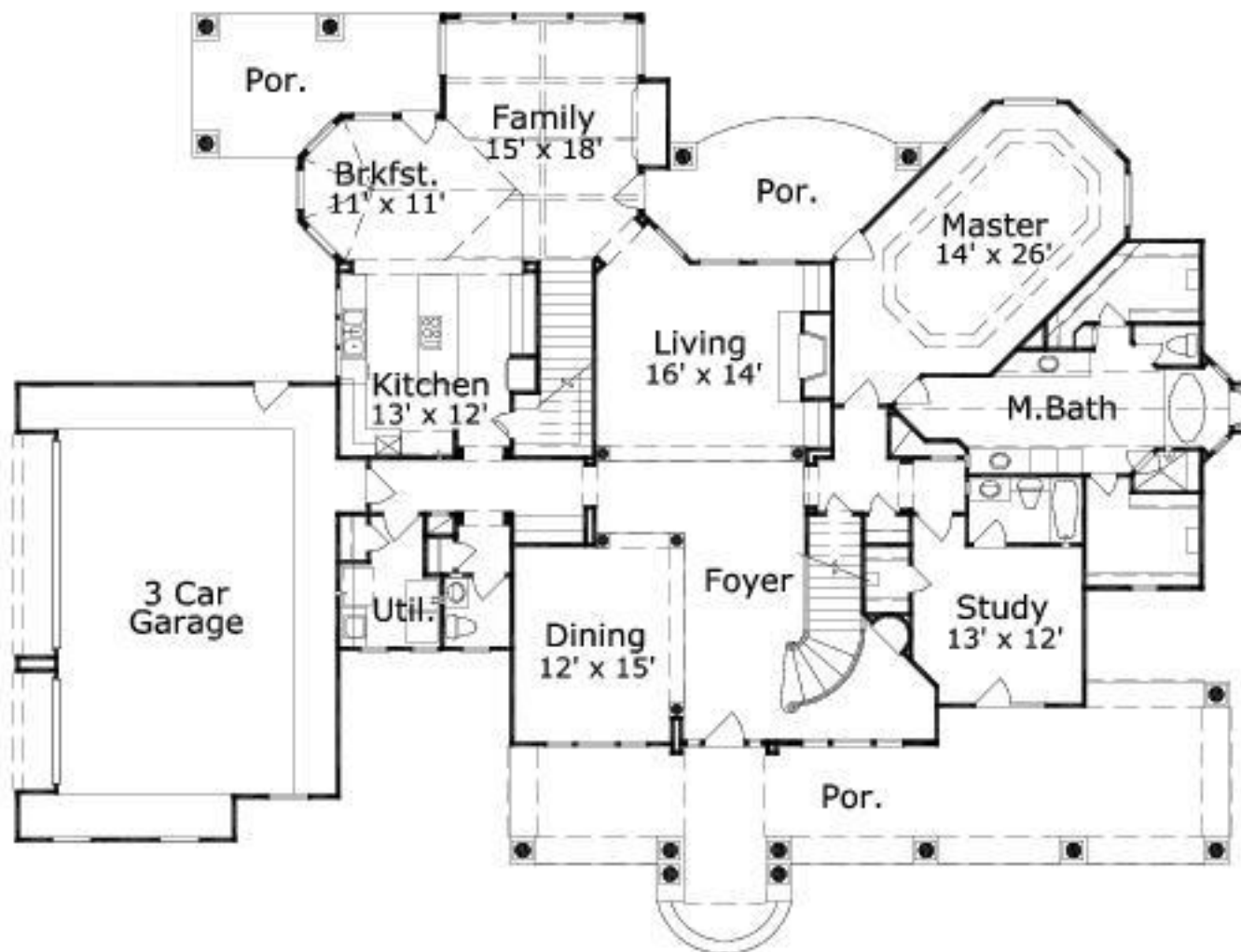

Blairmore 4340: Floor 2

