

Starry Night 6504: Details

AS LOW AS \$250
FULLY CUSTOMIZABLE &
PROFESSIONALLY DESIGNED

Style	Traditional
Exterior Materials	Brick & Cultured Stone
Bedrooms	5
Bathrooms	5 / 1
Total Living Sq Ft	6,504
Total Covered Sq Ft	8,726
Dimensions (w x d x h)	99'8" x 103'2" x 39'1"

	First Floor	Other Floors	Other Features		
Square Footage	4,373	2,131	Art Niche	Foyer	Terrace
Bedrooms	1	4	Bar	Gallery	Theater/Media
Ceiling Heights	11'0"	9'0"	Butler Pantry	Hidden Storage	
Master Bedroom	X		Cabana Bath	Interior Balcony	
Dining Room	X		Cedar Closet	Master Fireplaces	
Living Room	X		Christmas Storage	Master with Sitting Area	
Family Room	X		Coffee/Juice Bar	Optional Elevator	
Game Room		X	Computer Alcove	Outdoor Kitchen	
Study	X		Covered Pavilion	Playroom	
Guest Room		X	Covered Rear Porch	Quarters	
Home Theater		X	Covered Terrace	Sports Closet	

Garage(s) Side Load Swing (Entry Facing)
Stairs Split (2 flights)

Notes

The living area of this floor plan does not include the second floor sunken bedroom 5/quarters. The additional square footage for the sunken bedroom 5/quarters is 738 square feet.

Starry Night 6504: Front Elevation



Starry Night 6504: Floor 1

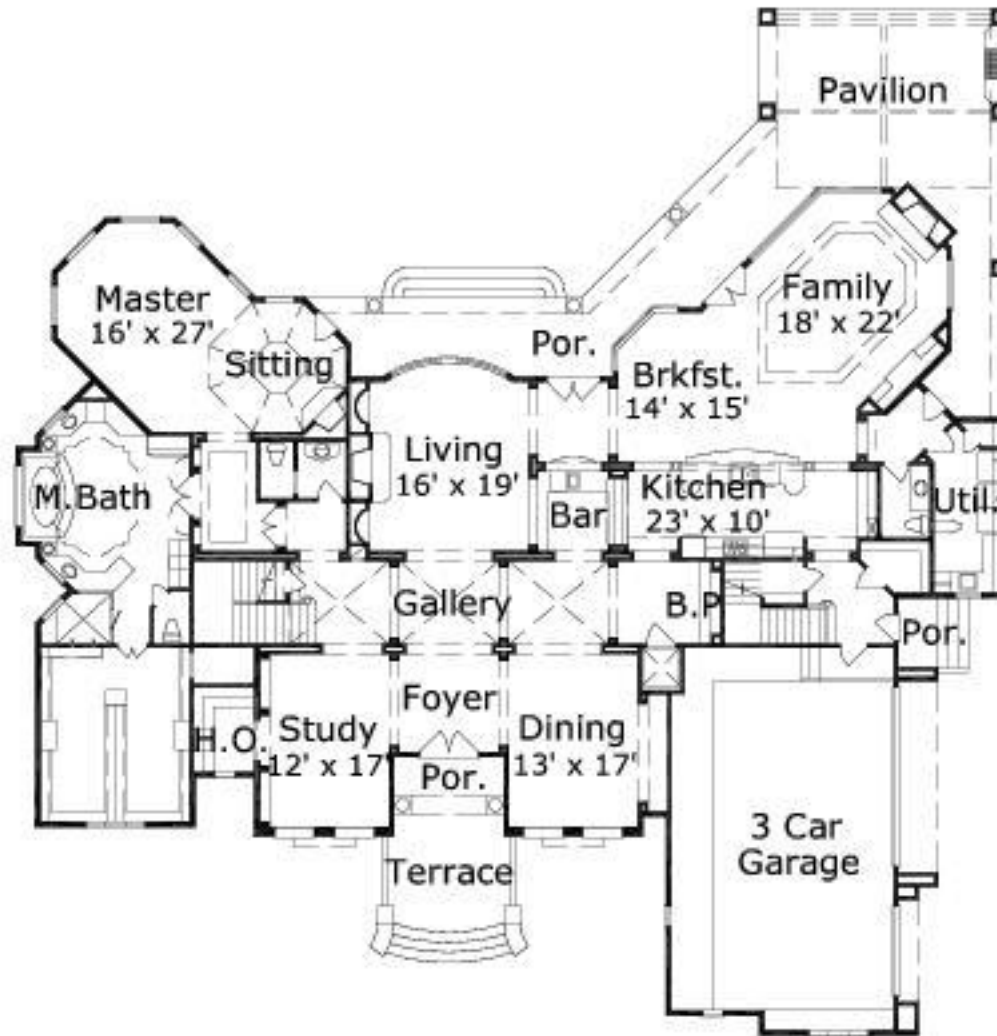

Starry Night 6504: Floor 2

