

## The Breathless 11226: Details

**AS LOW AS \$250**  
**FULLY CUSTOMIZABLE &**  
**PROFESSIONALLY DESIGNED**

<b>Style</b>	Mediterranean
<b>Exterior Materials</b>	Stucco
<b>Bedrooms</b>	6
<b>Bathrooms</b>	5 / 2
<b>Total Living Sq Ft</b>	11,226
<b>Total Covered Sq Ft</b>	18,028
<b>Dimensions (w x d x h)</b>	202'0" x 95'0" x 37'1"

	First Floor	Other Floors	Other Features
<b>Square Footage</b>	7,305	3,921	Bar Covered Terrace Playroom
<b>Bedrooms</b>	2	4	Bonus Room Exercise Room Quarters
<b>Ceiling Heights</b>	12'0"	10'0"	Buffet Exterior Balcony Rotunda
<b>Master Bedroom</b>	X		Butler Pantry Foyer Second Utility Room
<b>Dining Room</b>	X		Cabana Bath Gallery Theater/Media
<b>Living Room</b>	X		Coffee/Juice Bar Interior Balcony Tile Roof
<b>Family Room</b>	X		Computer Alcove Kitchenette Unfinished Storage
<b>Game Room</b>		X	Covered Front Porch Loggia
<b>Study</b>	X		Covered Pavilion Master with Sitting Area
<b>Guest Room</b>	X		Covered Rear Porch Main Entry
<b>Home Theater</b>		X	Covered Side Porch Outdoor Kitchen

<b>Garage(s)</b>	Front Load Swing (Side Facing)
<b>Stairs</b>	Spiral (2 flights)

## The Breathless 11226: Front Elevation



## The Breathless 11226: Floor 1

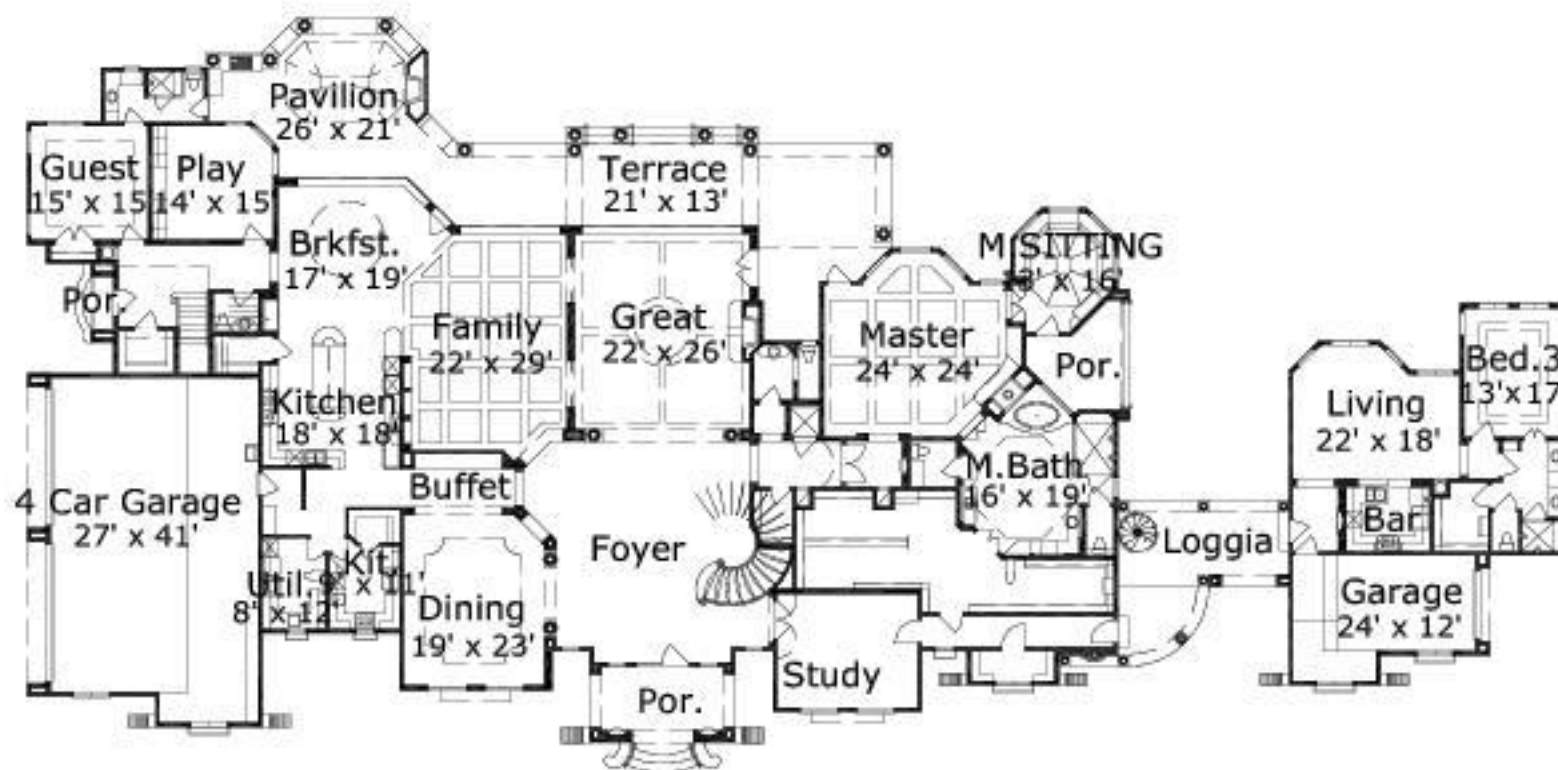

## The Breathless 11226: Floor 2

