

The Dartmoor 7015: Details

AS LOW AS \$250
FULLY CUSTOMIZABLE &
PROFESSIONALLY DESIGNED

Style	French
Exterior Materials	Stucco
Bedrooms	4
Bathrooms	4 / 3
Total Living Sq Ft	7,015
Total Covered Sq Ft	9,345
Dimensions (w x d x h)	88'8" x 116'10" x 35'7"

	First Floor	Other Floors	Other Features
Square Footage	4,449	2,566	Bar Master with Sitting Area
Bedrooms	1	3	Bonus Room Mud Entry
Ceiling Heights	10'0"	9'0"	Butler Pantry Outdoor Fireplace
Master Bedroom	X		Cabana Bath Outdoor Kitchen
Dining Room	X		Coffee/Juice Bar Playroom
Family Room	X		Covered Pavilion Quarters
Game Room		X	Covered Rear Porch Separate Master Closet
Study	X		Exercise Room Shop
Guest Room		X	Foyer Two Story Family Room
			Gallery Unfinished Storage
			Kitchenette

Garage(s)	Front Load Swing (Entry Facing)
Stairs	Standard (2 flights)

The Dartmoor 7015: Front Elevation



The Dartmoor 7015: Floor 1

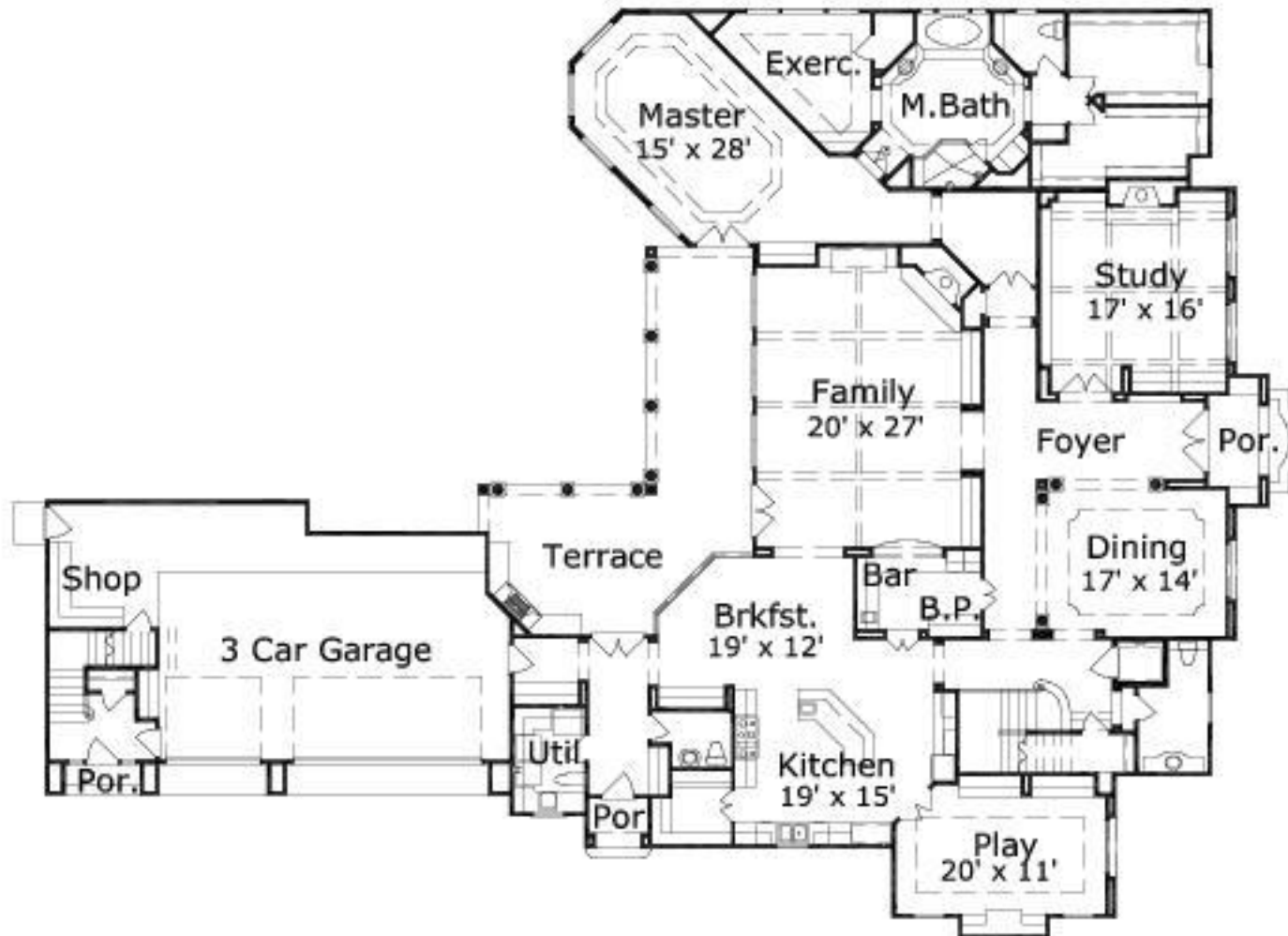

The Dartmoor 7015: Floor 2

