

## The Alben 4760: Details

**AS LOW AS \$250**  
**FULLY CUSTOMIZABLE &**  
**PROFESSIONALLY DESIGNED**

<b>Style</b>	Country French
<b>Exterior Materials</b>	Stucco & Cultured Stone
<b>Bedrooms</b>	4
<b>Bathrooms</b>	4 / 1
<b>Total Living Sq Ft</b>	4,760
<b>Total Covered Sq Ft</b>	6,379
<b>Dimensions (w x d x h)</b>	89'2" x 79'6" x 35'4"

	First Floor	Other Floors	Other Features
<b>Square Footage</b>	3,131	1,629	Butler Pantry    Optional Balcony
<b>Bedrooms</b>	1	3	Cabana Bath    Outdoor Kitchen
<b>Ceiling Heights</b>	10'0"	9'0"	Coffee/Juice Bar    Separate Master Closet
<b>Master Bedroom</b>	X		Computer AlcoveShop
<b>Dining Room</b>	X		Covered PavilionTexas Basement
<b>Family Room</b>	X		Covered Rear PorchUnfinished Storage
<b>Game Room</b>		X	Dark Room    Wine Closet
<b>Study</b>	X		Exercise Room
<b>Guest Room</b>		X	Hobby Room
			Master with Sitting Area
			Mud Entry
<b>Garage(s)</b>	Front Load Split		
<b>Stairs</b>	Standard		

## The Alben 4760: Front Elevation



## The Alben 4760: Floor 1

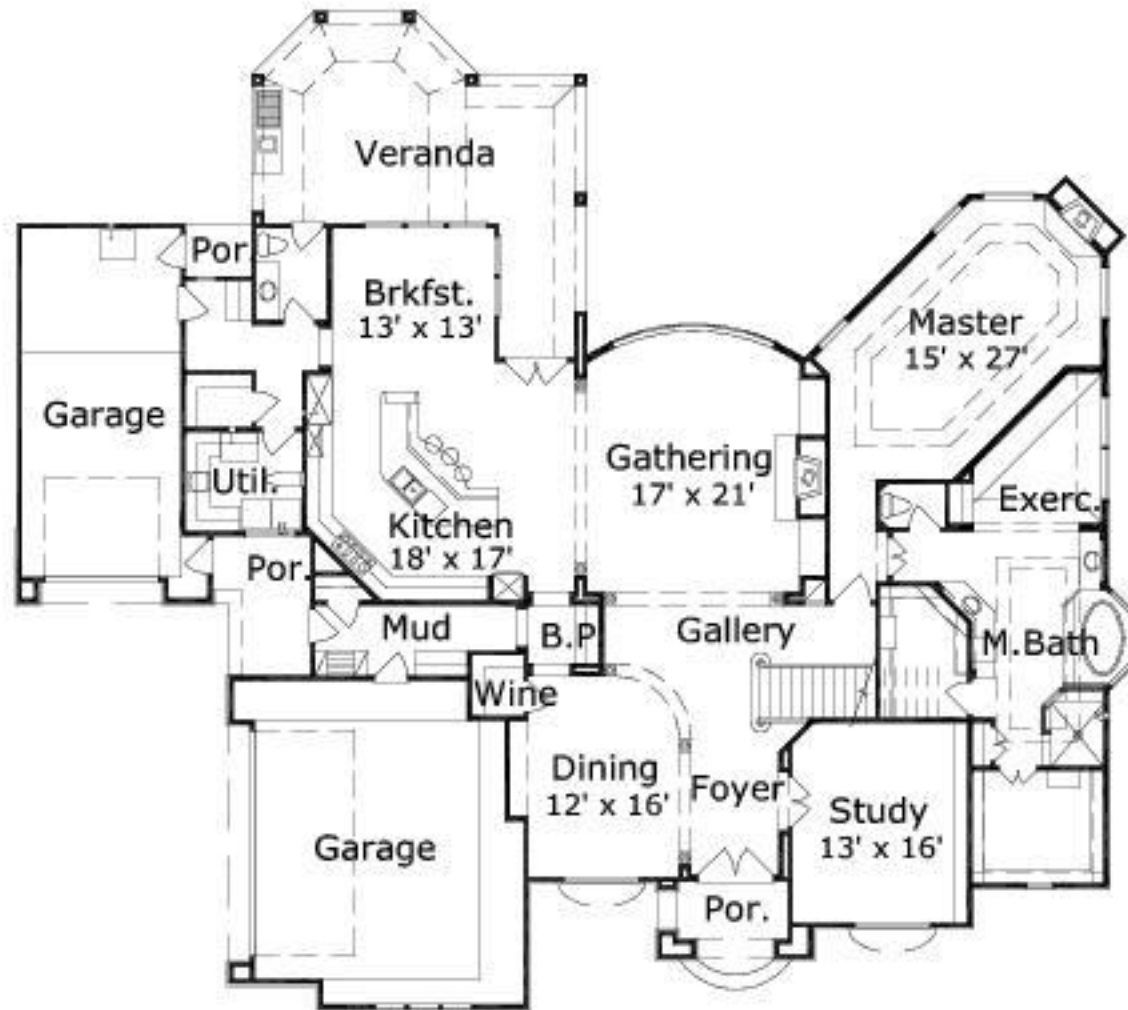

## The Alben 4760: Floor 2

