

## Primm Valley 5498 : Details

**AS LOW AS \$250**  
**FULLY CUSTOMIZABLE &**  
**PROFESSIONALLY DESIGNED**

<b>Style</b>	Transitional
<b>Exterior Material</b>	Stucco
<b>Bedrooms</b>	5
<b>Bathrooms</b>	5 / 1
<b>Total Living Sq Ft</b>	5,498
<b>Total Covered Sq Ft</b>	7,573
<b>Dimensions (w x d x h)</b>	103' 2" x 78' 4" x 34' 1"

	First Floor	Other Floors	Other Features	
<b>Square Footage</b>	3,716	1,782	Cov'd. Pavilion	Ext. Balcony
<b>Master Bedroom</b>	X		Foyer	Gallery
<b>Dining Room</b>	X		Mud Room	
<b>Living Room</b>	X			
<b>Family Room</b>	X			
<b>Study</b>	X			
<b>Guest Room</b>	X			

**Garage(s)** 3 car, Front Load, Split  
**Stairs**

## Primm Valley 5498 : Front Elevation



# Primm Valley 5498 : Floor 1

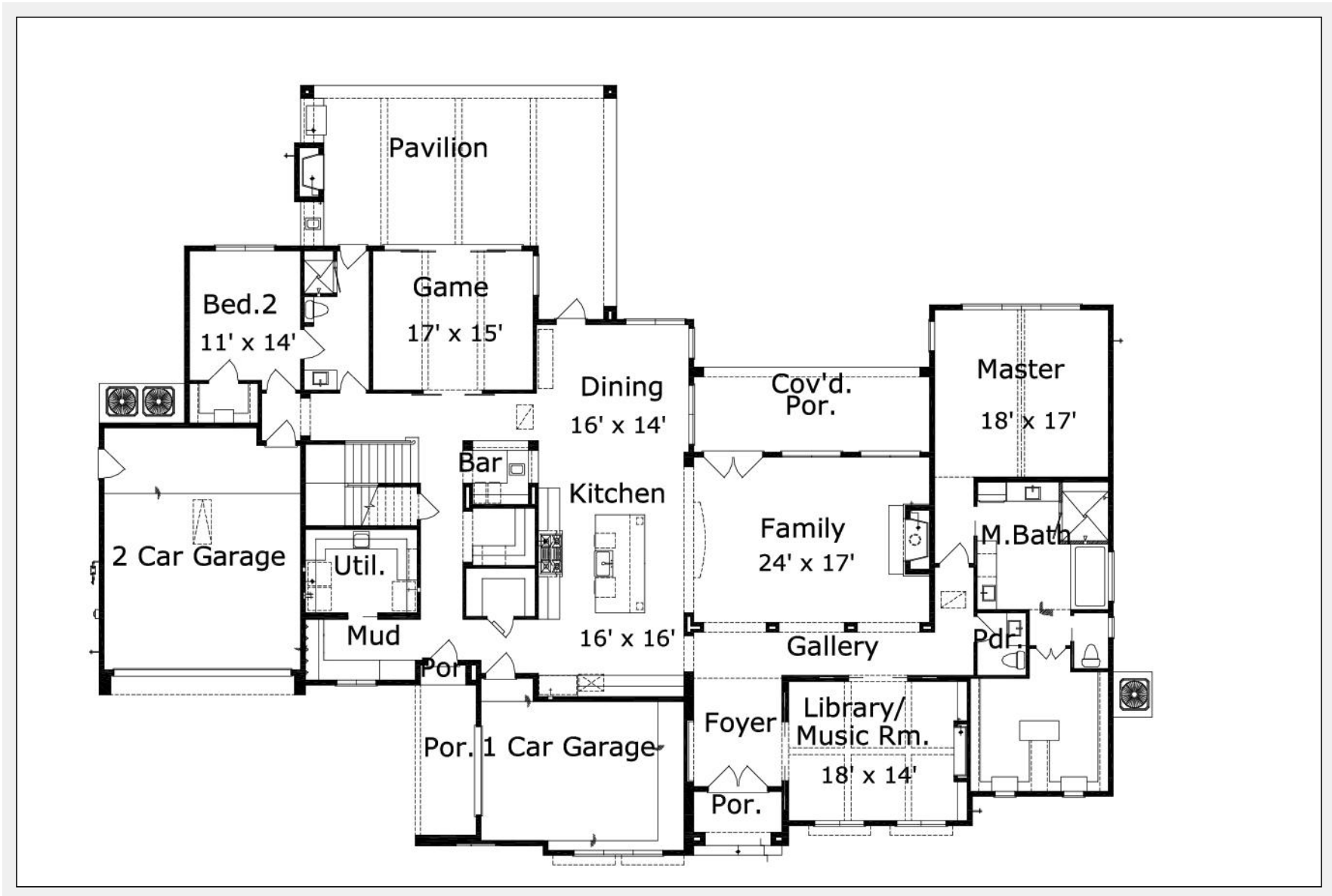

## Primm Valley 5498 : Floor 2

