

## Perth 2702 : Details

**AS LOW AS \$250**  
**FULLY CUSTOMIZABLE &**  
**PROFESSIONALLY DESIGNED**

<b>Style</b>	Transitional
<b>Exterior Material</b>	Brick & Siding
<b>Bedrooms</b>	3
<b>Bathrooms</b>	3 / 1
<b>Total Living Sq Ft</b>	2,702
<b>Total Covered Sq Ft</b>	3,535
<b>Dimensions (w x d x h)</b>	31' 2" x 63' 6" x 34' 11"

	First Floor	Other Floors	Other Features	
<b>Square Footage</b>	1,015	1,687	Bar	Cov'd. Rear Porch
<b>Master Bedroom</b>		X	Foyer	Loft
<b>Dining Room</b>	X		Master Up	
<b>Living Room</b>	X			
<b>Family Room</b>	X			
<b>Guest Room</b>		X		

**Garage(s)** 2 car, Front Load, Straight In  
**Stairs**

## Perth 2702 : Front Elevation



## Perth 2702 : Floor 1

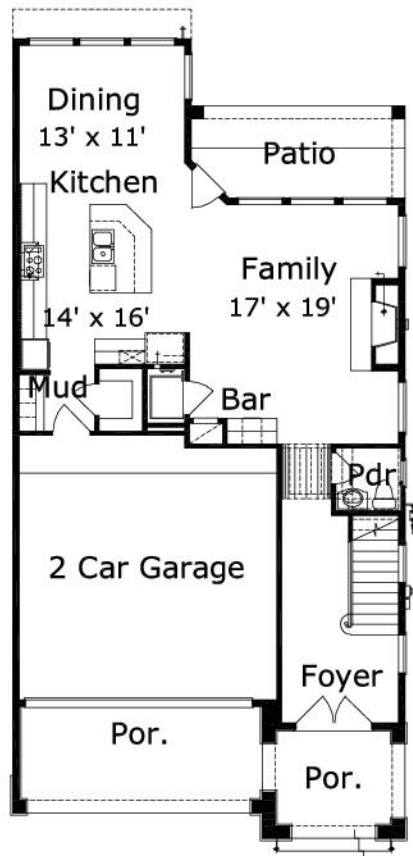

## Perth 2702 : Floor 2

