

## Gretel 4814 : Details

**AS LOW AS \$250**  
**FULLY CUSTOMIZABLE &**  
**PROFESSIONALLY DESIGNED**

<b>Style</b>	Country French
<b>Exterior Material</b>	Stone & Stucco
<b>Bedrooms</b>	4
<b>Bathrooms</b>	4 / 1
<b>Total Living Sq Ft</b>	4,814
<b>Total Covered Sq Ft</b>	6,155
<b>Dimensions (w x d x h)</b>	70' 8" x 79' 8" x 32' 10"

	First Floor	Other Floors	Other Features	
<b>Square Footage</b>	2,961	1,853	Butler Pantry	Cov'd. Pavilion
<b>Master Bedroom</b>	X		Cov'd. Terrace	Foyer
<b>Dining Room</b>	X		Home Office	Int. Balcony
<b>Living Room</b>	X		Master Down	Mud Entry
<b>Family Room</b>	X		Outdoor Fireplace	Outdoor Kitchen
<b>Game Room</b>		X		
<b>Study</b>	X			
<b>Guest Room</b>		X		
<b>Home Theater</b>		X		

**Garage(s)** 3 car, Front Load, Straight In  
**Stairs**

## Gretel 4814 : Front Elevation



## Gretel 4814 : Floor 1

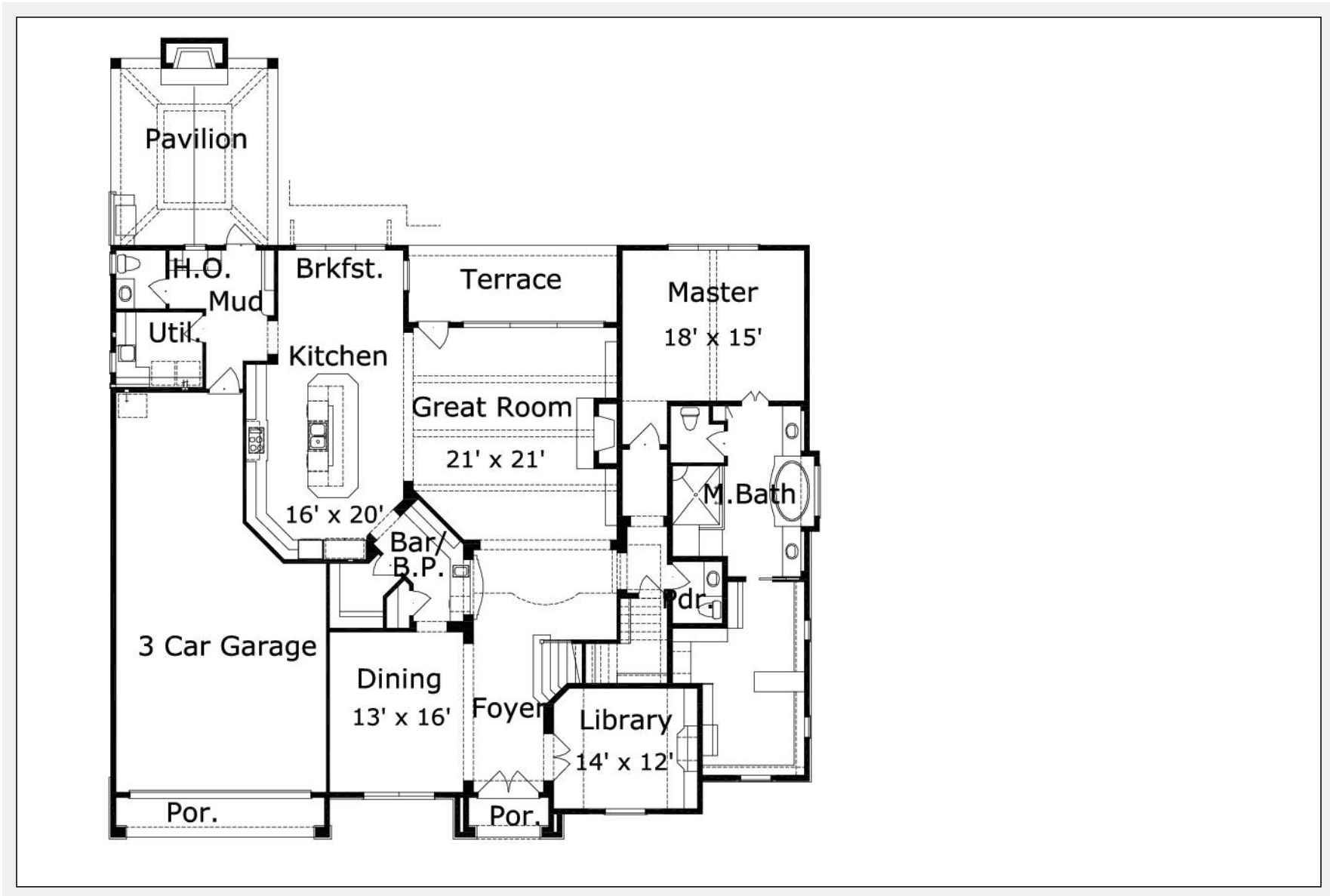

## Gretel 4814 : Floor 2

