

Sentinal 6342 : Details

AS LOW AS \$250
FULLY CUSTOMIZABLE &
PROFESSIONALLY DESIGNED

| | |
|-------------------------------|--------------------------|
| Style | Mediterranean |
| Exterior Material | Stucco |
| Bedrooms | 4 |
| Bathrooms | 4 / 2 |
| Total Living Sq Ft | 6,342 |
| Total Covered Sq Ft | 8,644 |
| Dimensions (w x d x h) | 99' 0" x 93' 6" x 34' 4" |

| | First Floor | Other Floors | Other Features | |
|-----------------------|-------------|--------------|----------------|-----------------|
| Square Footage | 4,291 | 2,051 | Arbor | Bar |
| Master Bedroom | X | | Butler Pantry | Cov'd. Pavilion |
| Dining Room | X | | Cov'd. Terrace | Foyer |
| Living Room | X | | Gallery | Wine Room |
| Family Room | X | | | |
| Study | X | | | |
| Guest Room | | X | | |

| | |
|------------------|--|
| Garage(s) | 3 car, Front Load, Swing (Side Facing) |
| Stairs | Standard |

Sentinal 6342 : Front Elevation



Sentinal 6342 : Floor 1

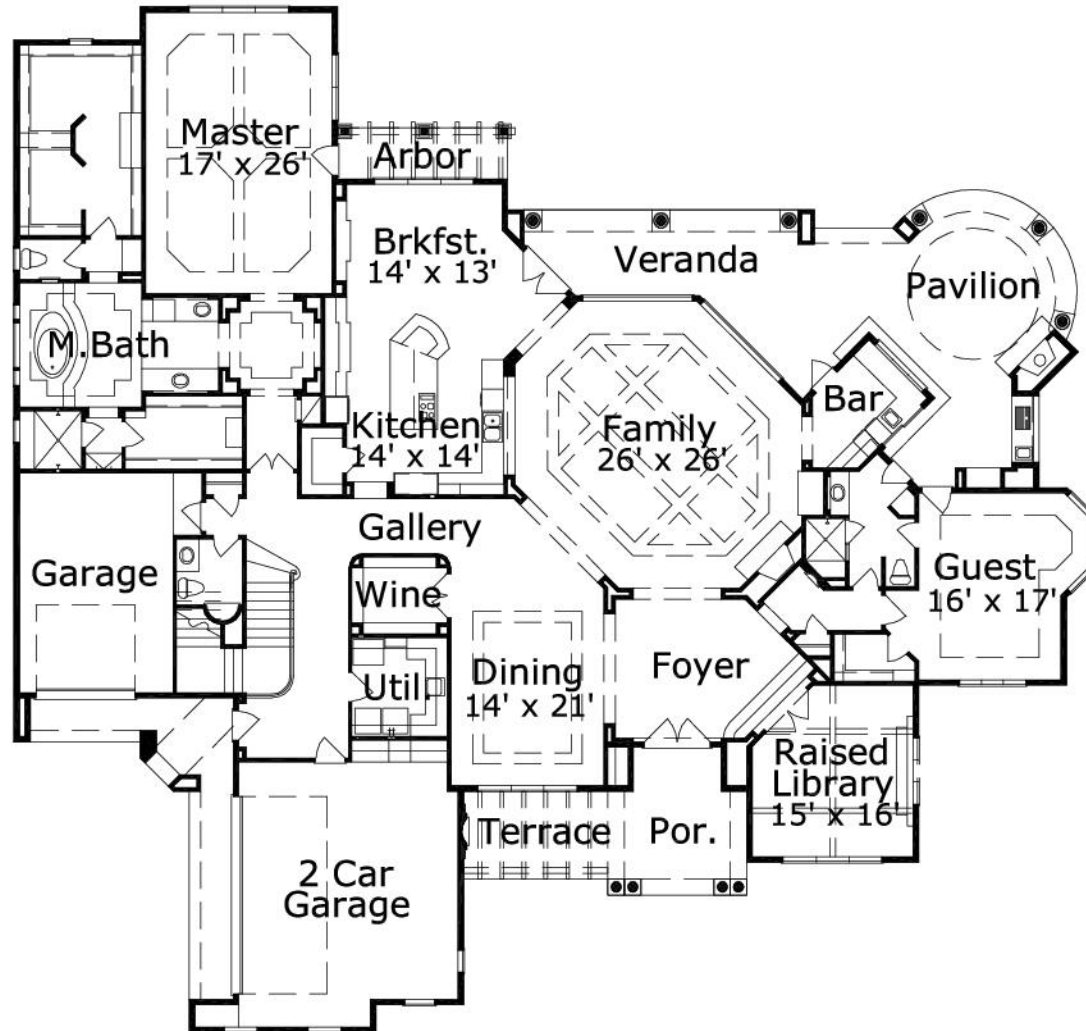

Sentinal 6342 : Floor 2

