

## Slashwood 3025.3 : Details

**AS LOW AS \$250**  
**FULLY CUSTOMIZABLE &**  
**PROFESSIONALLY DESIGNED**

<b>Style</b>	Traditional
<b>Exterior Material</b>	Brick
<b>Bedrooms</b>	4
<b>Bathrooms</b>	3 / 1
<b>Total Living Sq Ft</b>	3,025
<b>Total Covered Sq Ft</b>	3,789
<b>Dimensions (w x d x h)</b>	55' 0" x 51' 2" x 29' 8"

	First Floor	Other Floors	Other Features	
<b>Square Footage</b>	1,090	1,127	Bonus Room	Gallery
<b>Master Bedroom</b>	X			
<b>Dining Room</b>	X			
<b>Living Room</b>	X			
<b>Family Room</b>	X			
<b>Study</b>	X			
<b>Garage(s)</b>	car, ,			
<b>Stairs</b>	Standard			

## Slashwood 3025.3 : Front Elevation



## Slashwood 3025.3 : Floor 1

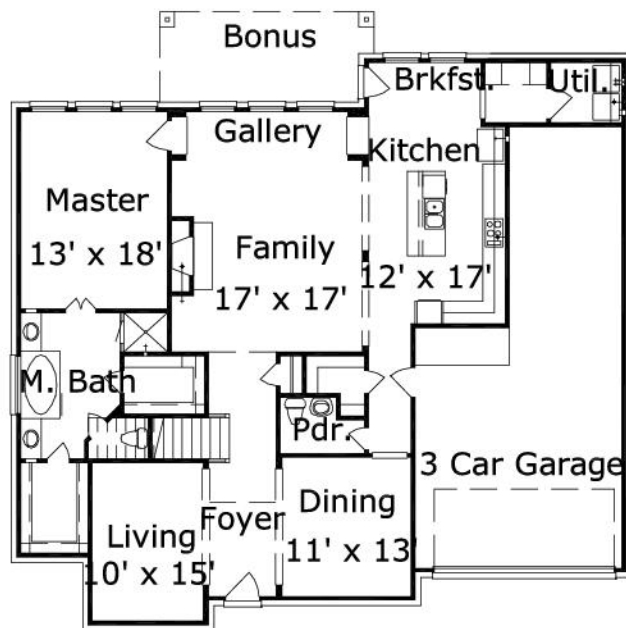

## Slashwood 3025.3 : Floor 2

