

Glenoak 2632 : Details

AS LOW AS \$250
FULLY CUSTOMIZABLE &
PROFESSIONALLY DESIGNED

Style	Victorian
Exterior Material	Brick & Siding
Bedrooms	4
Bathrooms	3 / 1
Total Living Sq Ft	2,632
Total Covered Sq Ft	3,685
Dimensions (w x d x h)	39' 5" x 87' 0" x 39' 2"

	First Floor	Other Floors	Other Features	
Square Footage	1,637	995	Foyer	Gallery
Master Bedroom	X		Loft	
Dining Room	X			
Living Room	X			
Family Room	X			
Study	X			
Guest Room		X		

Garage(s) 2 car, Rear Load, Straight In
Stairs Curved

Glenoak 2632 : Front Elevation



Glenoak 2632 : Floor 1

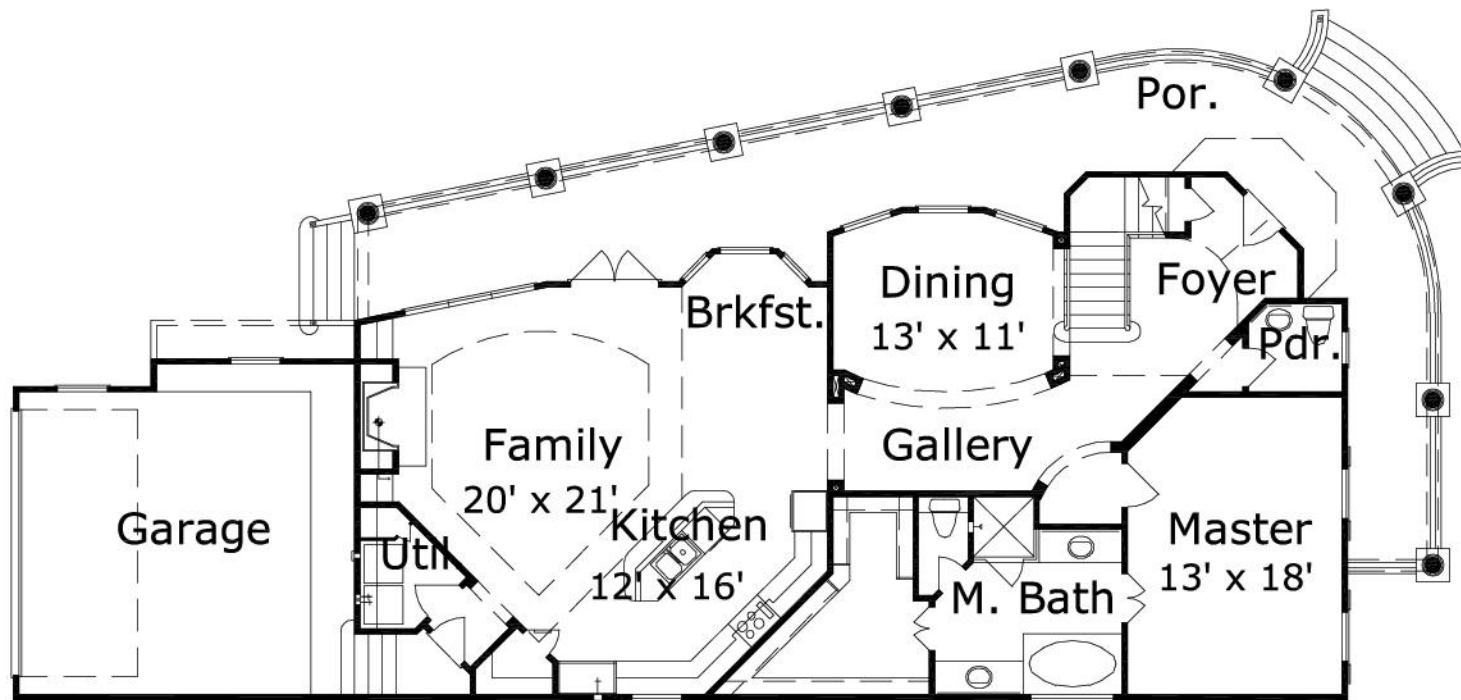

Glenoak 2632 : Floor 2

