

## Salisbury 6858 : Details

**AS LOW AS \$250**  
**FULLY CUSTOMIZABLE &**  
**PROFESSIONALLY DESIGNED**

<b>Style</b>	Tuscan
<b>Exterior Material</b>	Stone & Stucco
<b>Bedrooms</b>	5
<b>Bathrooms</b>	5 / 2
<b>Total Living Sq Ft</b>	6,858
<b>Total Covered Sq Ft</b>	9,629
<b>Dimensions (w x d x h)</b>	129' 2" x 106' 8" x 34' 1"

	First Floor	Other Floors	Other Features	
<b>Square Footage</b>	4,716	2,142	Bar	Butler Pantry
<b>Master Bedroom</b>	X		Cov'd. Pavilion	Foyer
<b>Dining Room</b>	X		Gallery	Home Office
<b>Living Room</b>	X		Outdoor Fireplace	Outdoor Kitchen
<b>Family Room</b>	X			
<b>Game Room</b>		X		
<b>Study</b>	X			
<b>Guest Room</b>	X			
<b>Home Theater</b>		X		

<b>Garage(s)</b>	3 car, Front Load, Split
<b>Stairs</b>	Spiral

## Salisbury 6858 : Front Elevation



## Salisbury 6858 : Floor 1

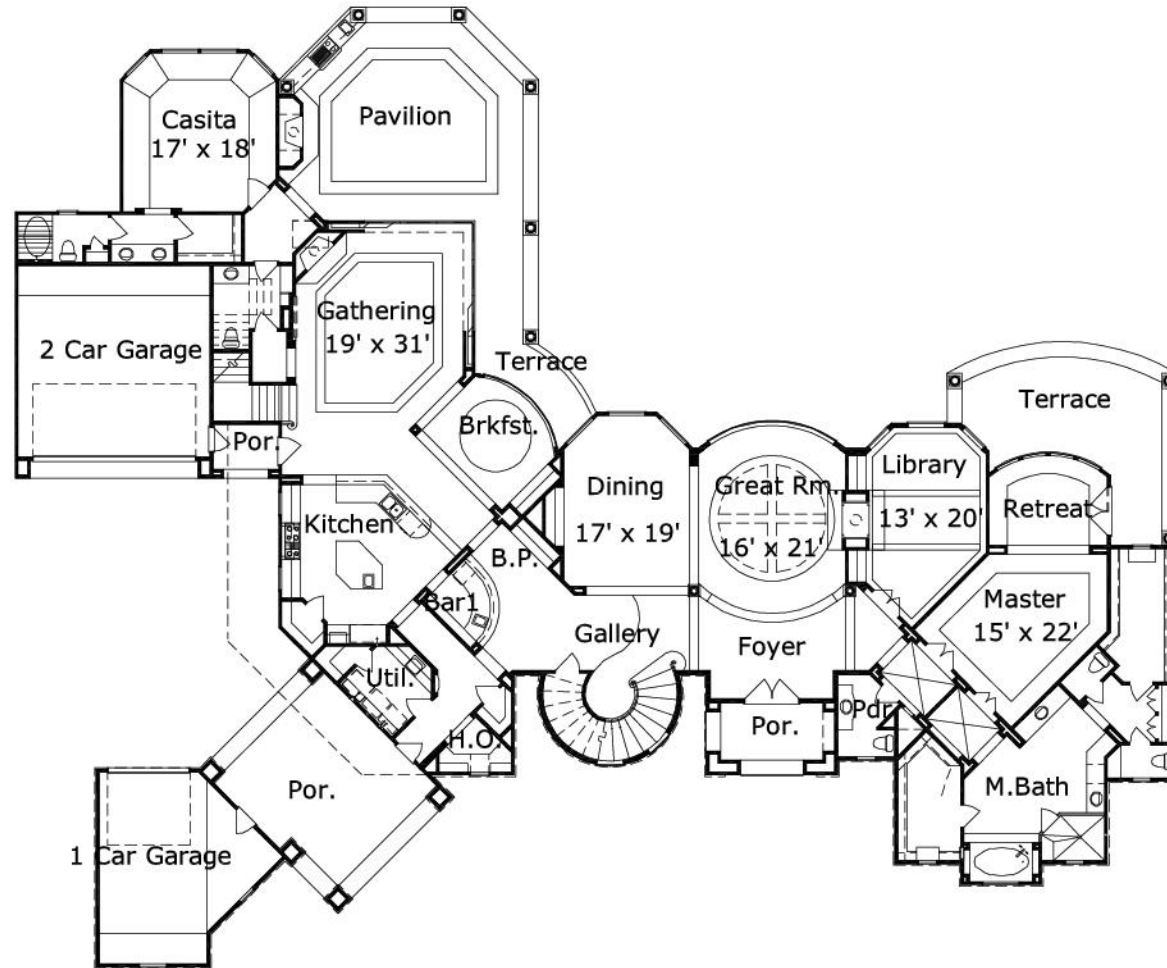

## Salisbury 6858 : Floor 2

