

## Hopewell 2378: Details

Style	Victorian
Exterior Materials	Siding
Bedrooms	3
Bathrooms	3 / 1
Total Living Sq Ft	2,378
Total Covered Sq Ft	3,728
Dimensions (w x d x h)	19'0" x 118'0" x 33'5"

**AS LOW AS \$250**  
**FULLY CUSTOMIZABLE &**  
**PROFESSIONALLY DESIGNED**

	First Floor	Other Floors	Other Features
Square Footage	1,105	1,273	Butler Pantry     Wine Closet
Bedrooms	0	3	Courtyard
Ceiling Heights	10'0"	9'0"	Cov'd. Front Porch
Master Bedroom		X	Cov'd. Rear Porch
Dining Room	X		Ext. Balcony
Living Room	X		Foyer
Family Room	X		Loft
Game Room		X	Rear Courtyard
Study	X		
Guest Room		X	
Garage(s)	Rear Load Straight In		
Stairs	Standard		

## Hopewell 2378: Front Elevation



## Hopewell 2378: Floor 1

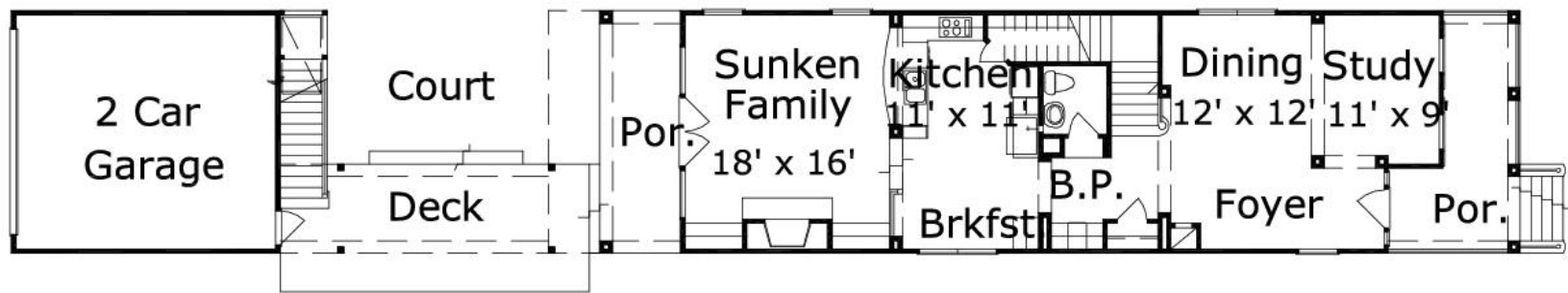

Hopewell 2378: Floor 2

