

Eddington 6232: Details

Style	Mediterranean
Exterior Materials	Stucco
Bedrooms	5
Bathrooms	5 / 1
Total Living Sq Ft	6,232
Total Covered Sq Ft	8,182
Dimensions (w x d x h)	65'0" x 121'0" x 0'0"

AS LOW AS \$250
FULLY CUSTOMIZABLE &
PROFESSIONALLY DESIGNED

	First Floor	Other Floors	Other Features
Square Footage	3,848	2,384	Butler Pantry
Bedrooms	1	4	Cov'd. Front Porch
Ceiling Heights	11'0"	10'0"	Cov'd. Rear Porch
Master Bedroom	X		Foyer
Dining Room	X		Gallery
Living Room	X		
Family Room	X		
Game Room		X	
Study	X		
Guest Room		X	
Garage(s)	Rear Load Straight In		
Stairs	Standard		

Eddington 6232: Front Elevation



Eddington 6232: Floor 1

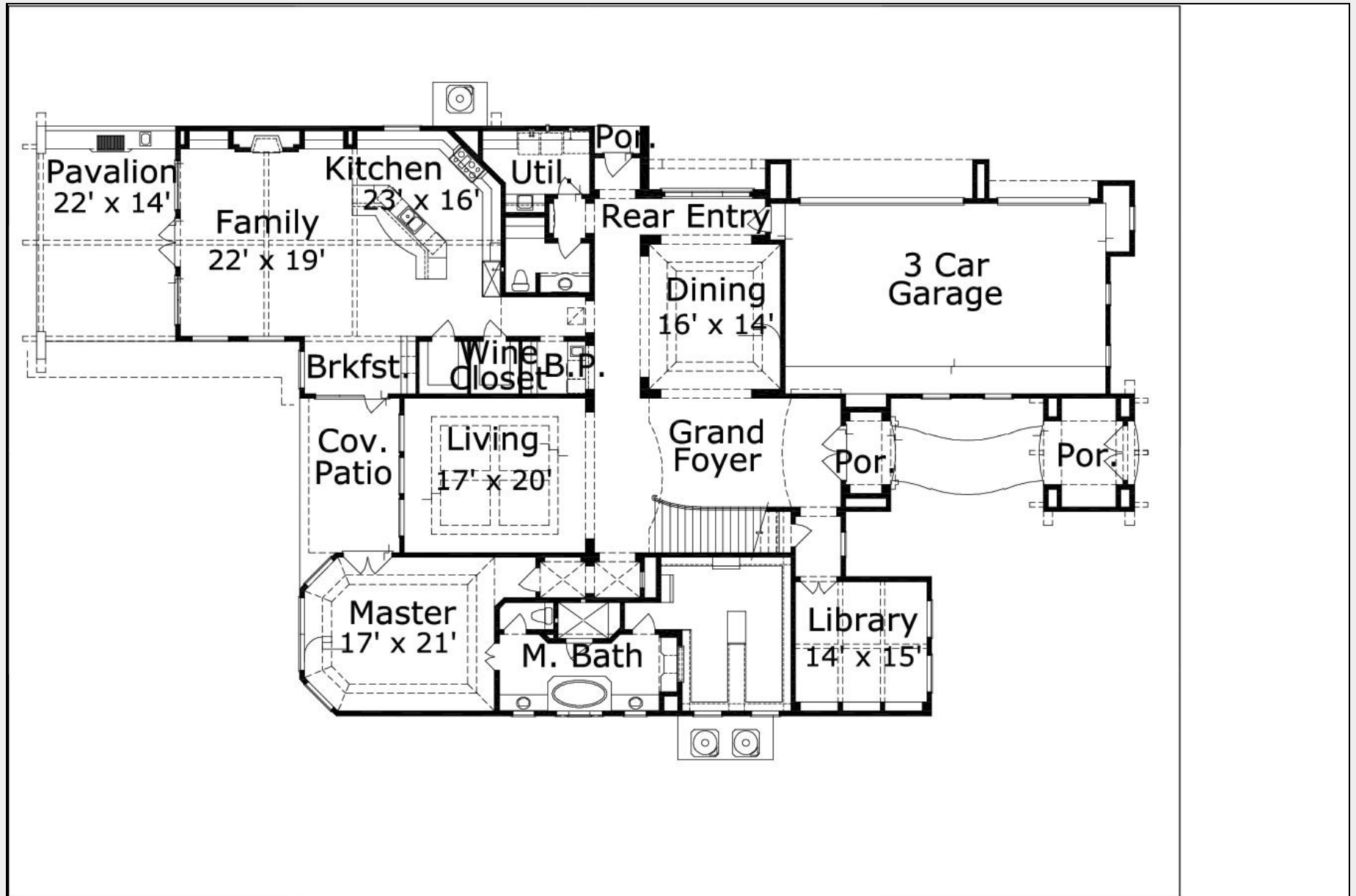

Eddington 6232: Floor 2

