

Chalfont 5232: Details

AS LOW AS \$250
FULLY CUSTOMIZABLE &
PROFESSIONALLY DESIGNED

Style	Mediterranean
Exterior Materials	Stucco
Bedrooms	6
Bathrooms	5 / 1
Total Living Sq Ft	5,232
Total Covered Sq Ft	7,116
Dimensions (w x d x h)	81'8" x 86'8" x 39'3"

	First Floor	Other Floors	Other Features
Square Footage	3,558	1,674	
Bedrooms	2	4	
Ceiling Heights	10'0"	9'0"	
Master Bedroom	X		
Dining Room	X		
Living Room	X		
Family Room	X		
Game Room		X	
Study	X		
Guest Room		X	
Home Theater		X	

Garage(s) Front Load Swing (Entry Facing)
Stairs Spiral (2 flights)

Notes

The living area of this plan does not include the future bedroom 6 or the optional guest room/home office. The additional square footage for the bedroom 6 is 314 square feet, and the additional square footage for the optional guest room is 342 square feet.

Chalfont 5232: Front Elevation



Chalfont 5232: Floor 1

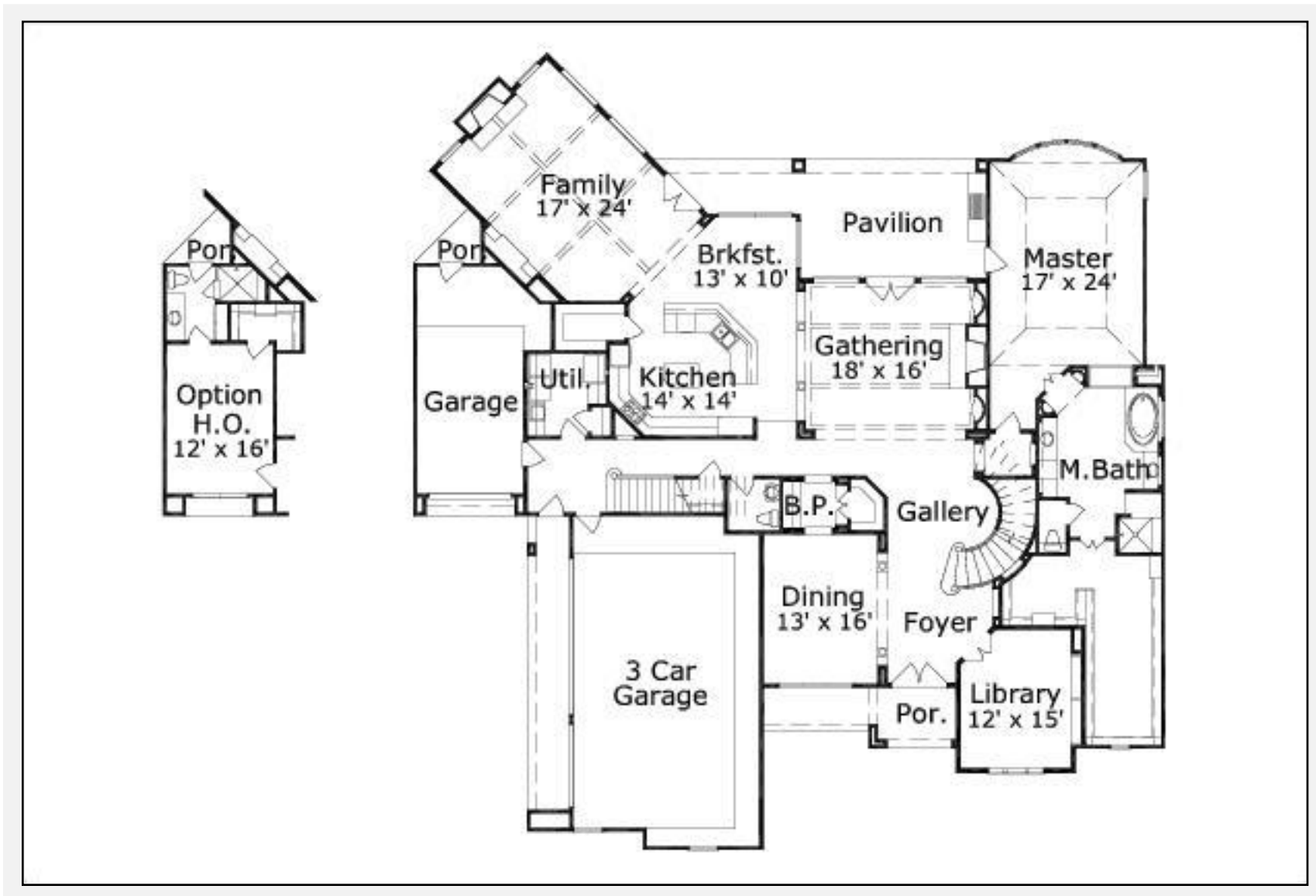

Chalfont 5232: Floor 2

