

Scheel 11877: Details

AS LOW AS \$250
FULLY CUSTOMIZABLE &
PROFESSIONALLY DESIGNED

Style	French
Exterior Materials	Stone
Bedrooms	8
Bathrooms	7 / 3
Total Living Sq Ft	11,877
Total Covered Sq Ft	17,143
Dimensions (w x d x h)	173'0" x 109'2" x 46'5"

	First Floor	Other Floors
--	-------------	--------------

Other Features	
----------------	--

Square Footage	7,779	4,098
Bedrooms	2	6
Ceiling Heights	12'0"	10'0"
Master Bedroom	X	
Dining Room	X	
Living Room	X	
Family Room	X	
Game Room		X
Guest Room	X	

Art Niche	Exercise Room	Playroom
Bar	Exterior Balcony	Second Utility Room
Butler Pantry	Foyer	Separate Master Closet
Cabana Bath	Gallery	Terrace
Cedar Closet	Hobby Room	
Christmas Storage	Home Office	
Coffee/Juice Bar	Interior Balcony	
Computer Alcove	Kitchenette	
Conservatory	Master with Sitting Area	
Covered Rear Porch	Motor Court	
Covered Terrace	Optional Elevator	

Garage(s)	Front Load Swing (Entry Facing)
Stairs	Standard (4 flights)

Notes

The living area of this plan does not include the future home office or quarters. The additional square footage for the future home office is 656 square feet. The additional square footage for the future home office is 625 square feet.

Scheel 11877: Front Elevation



Scheel 11877: Floor 1

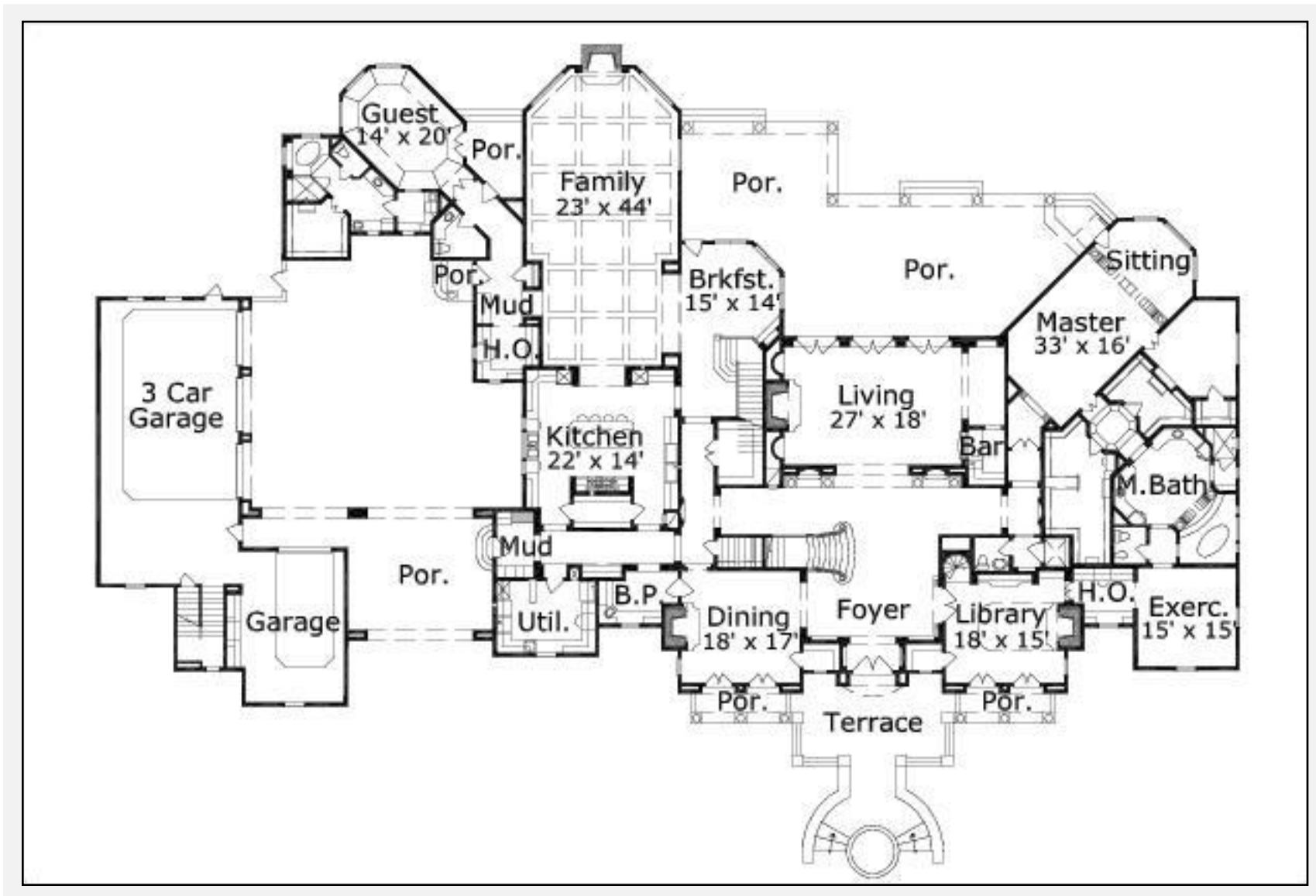

Scheel 11877: Floor 2

