

## Freestone Peach 8903: Details

**AS LOW AS \$250**  
**FULLY CUSTOMIZABLE &**  
**PROFESSIONALLY DESIGNED**

<b>Style</b>	Colonial
<b>Exterior Materials</b>	Brick & Siding
<b>Bedrooms</b>	5
<b>Bathrooms</b>	5 / 1
<b>Total Living Sq Ft</b>	8,903
<b>Total Covered Sq Ft</b>	13,882
<b>Dimensions (w x d x h)</b>	142'6" x 119'5" x 44'3"

	First Floor	Other Floors	Other Features
<b>Square Footage</b>	6,486	2,417	Bar Hidden Storage Wine Room
<b>Bedrooms</b>	2	3	Breezeway Home Office
<b>Ceiling Heights</b>	12'0"	10'0"	Christmas Storage Interior Balcony
<b>Master Bedroom</b>	X		Cocktail Lounge Master Fireplace
<b>Dining Room</b>	X		Conservatory Master with Sitting Area
<b>Living Room</b>	X		Covered Front Porch Outdoor Kitchen
<b>Family Room</b>	X		Covered Terrace Playroom
<b>Game Room</b>	X		Exercise Room Porte Cochere
<b>Study</b>	X		Exterior Balcony Sports Closet
<b>Guest Room</b>	X		Foyer Terrace
			Gallery Unfinished Storage
<b>Garage(s)</b>	Front Load Straight In		
<b>Stairs</b>	Curved (2 flights)		

## Freestone Peach 8903: Front Elevation



## Freestone Peach 8903: Floor 1

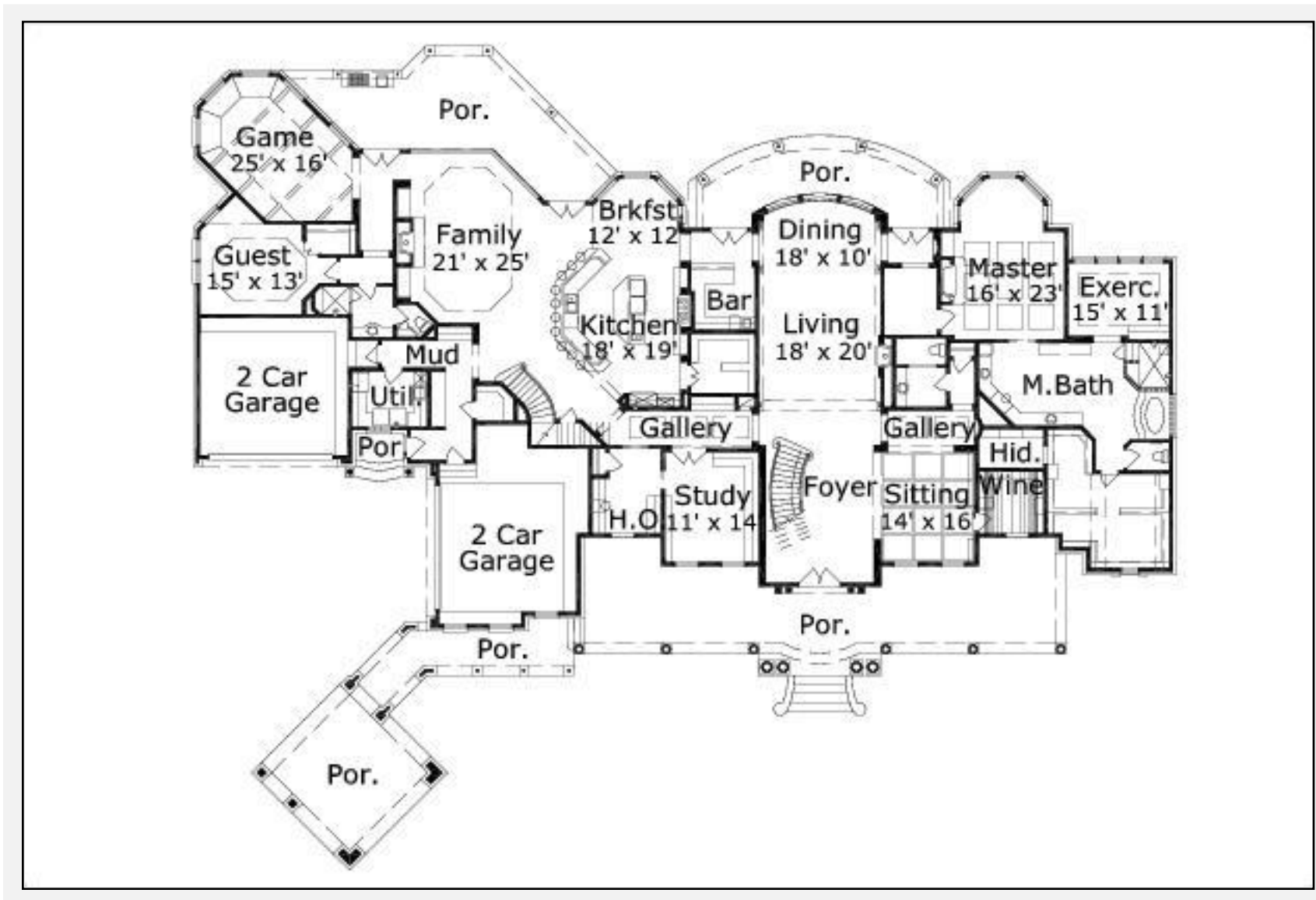

## Freestone Peach 8903: Floor 2

