

Kipling 5836: Details

AS LOW AS \$250
FULLY CUSTOMIZABLE &
PROFESSIONALLY DESIGNED

Style	Country Home
Exterior Materials	Brick & Stucco
Bedrooms	5
Bathrooms	5 / 1
Total Living Sq Ft	5,836
Total Covered Sq Ft	8,750
Dimensions (w x d x h)	138'4" x 89'10" x 37'2"

	First Floor	Other Floors	Other Features
Square Footage	4,220	1,616	Butler Pantry
Bedrooms	2	3	Covered Front Porch
Ceiling Heights	10'0"	9'0"	Covered Rear Porch
Master Bedroom	X		Exercise Room
Dining Room	X		Foyer
Living Room	X		Gallery
Family Room	X		Home Office
Game Room		X	Interior Balcony
Study	X		Playroom
Guest Room		X	Porte Cochere
			Separate Master Closet

Garage(s)	Rear Load Straight In
Stairs	Spiral (2 flights)

Notes

The living area in this plan does not include the third story loft. The additional square footage for the third story loft is 118 square feet.

Kipling 5836: Front Elevation



Kipling 5836: Floor 1

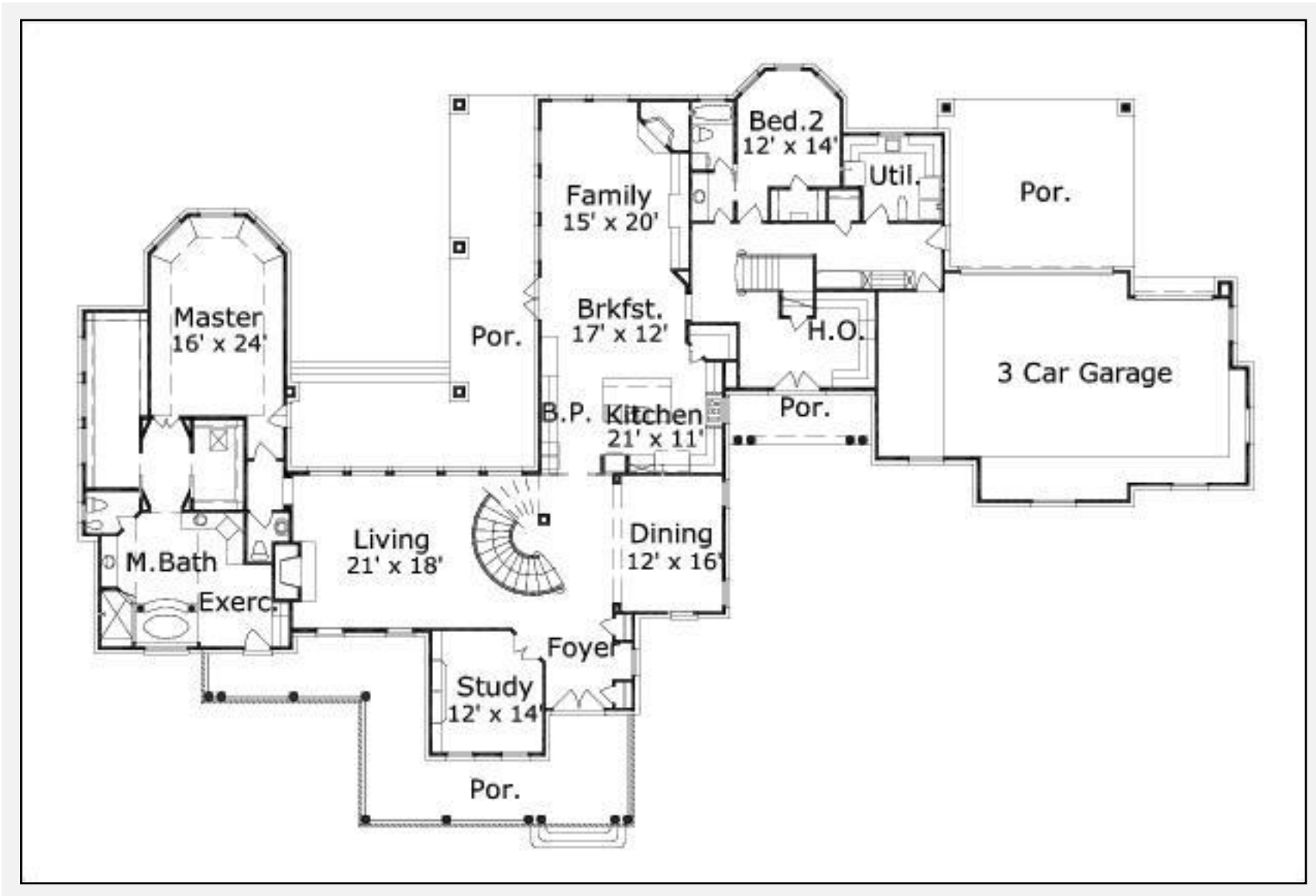

Kipling 5836: Floor 2

