

## Paxton 4600: Details

**AS LOW AS \$250**  
**FULLY CUSTOMIZABLE &**  
**PROFESSIONALLY DESIGNED**

<b>Style</b>	French
<b>Exterior Materials</b>	Stucco
<b>Bedrooms</b>	5
<b>Bathrooms</b>	3 / 2
<b>Total Living Sq Ft</b>	4,600
<b>Total Covered Sq Ft</b>	5,752
<b>Dimensions (w x d x h)</b>	74'0" x 73'0" x 33'11"

	First Floor	Other Floors	Other Features
<b>Square Footage</b>	3,007	1,593	Butler Pantry
<b>Bedrooms</b>	1	4	Covered Terrace
<b>Ceiling Heights</b>	10'0"	9'0"	Foyer
<b>Master Bedroom</b>	X		Gallery
<b>Dining Room</b>	X		Home Office
<b>Living Room</b>	X		Interior Balcony
<b>Family Room</b>	X		Master Fireplace
<b>Game Room</b>		X	Theater/Media
<b>Study</b>	X		
<b>Guest Room</b>		X	

<b>Garage(s)</b>	Side Load Swing (Entry Facing)
<b>Stairs</b>	Curved (2 flights)

## Paxton 4600: Front Elevation



## Paxton 4600: Floor 1

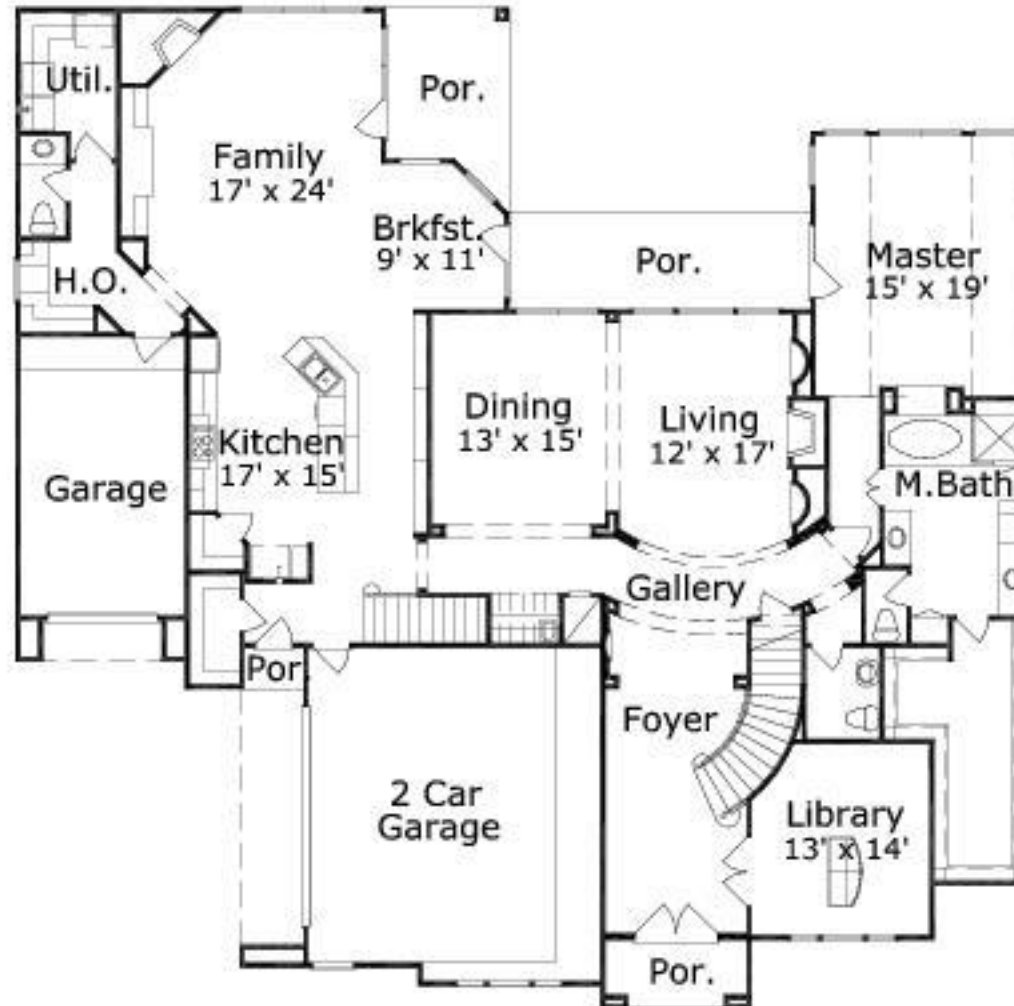

## Paxton 4600: Floor 2

