

Orchid Blossom 5025: Details

AS LOW AS \$250
FULLY CUSTOMIZABLE &
PROFESSIONALLY DESIGNED

Style	Country Home
Exterior Materials	Stone & Siding
Bedrooms	4
Bathrooms	4 / 1
Total Living Sq Ft	5,025
Total Covered Sq Ft	6,794
Dimensions (w x d x h)	119'1" x 51'4" x 31'0"

	First Floor	Other Floors	Other Features
Square Footage	4,227	798	Conservatory
Bedrooms	3	1	Exterior Balcony
Ceiling Heights	10'0"	9'0"	Foyer
Master Bedroom	X		Gallery
Dining Room	X		Master Fireplace
Living Room	X		Playroom
Family Room	X		
Game Room		X	
Study	X		
Guest Room	X		

Garage(s) Rear Load Swing (Entry Facing)
Stairs Split

Orchid Blossom 5025: Front Elevation



Orchid Blossom 5025: Floor 1

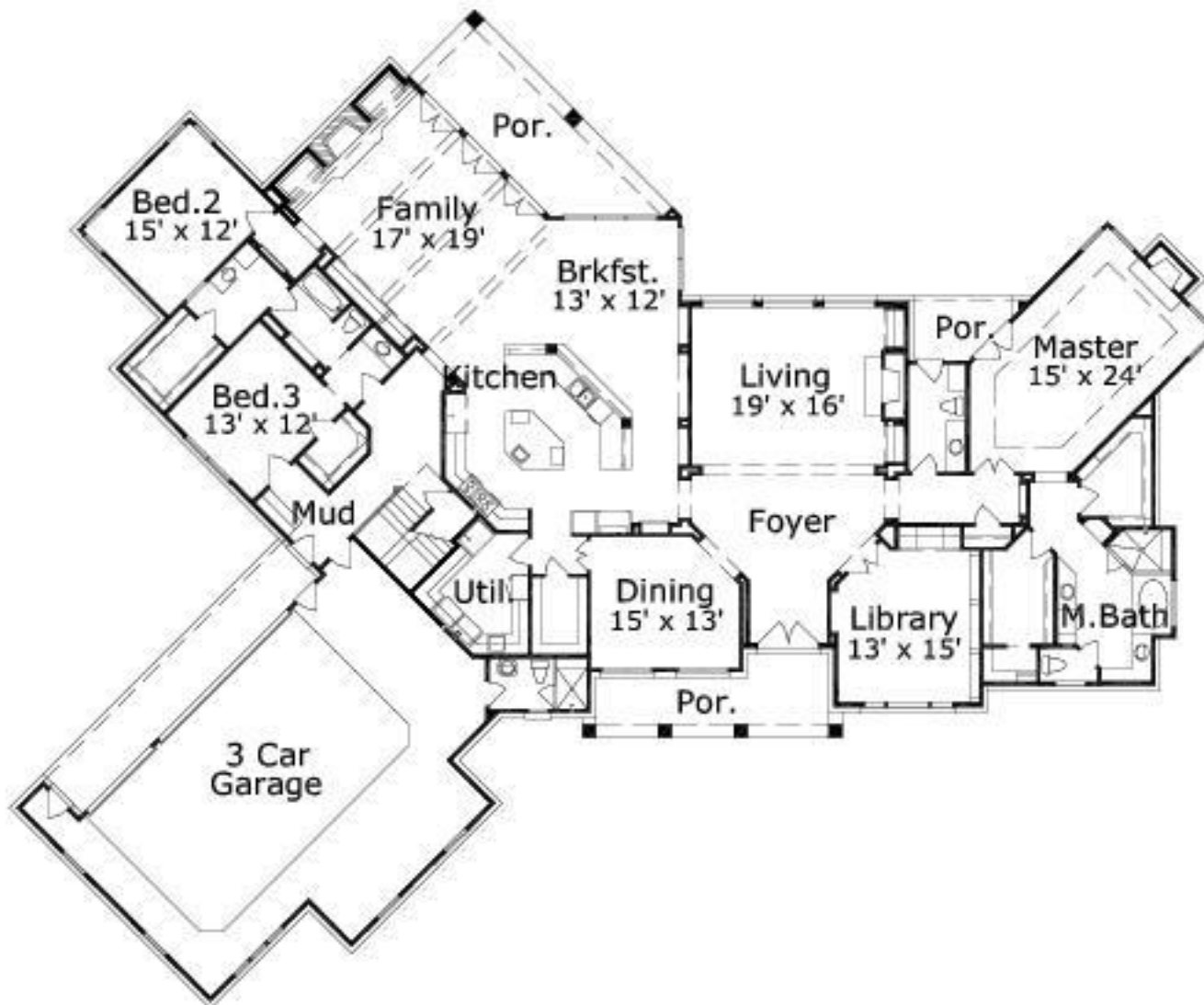

Orchid Blossom 5025: Floor 2

