

The Roper 4660: Details

AS LOW AS \$250
FULLY CUSTOMIZABLE &
PROFESSIONALLY DESIGNED

| | |
|-------------------------------|------------------------|
| Style | Traditional |
| Exterior Materials | Brick |
| Bedrooms | 4 |
| Bathrooms | 3 / 1 |
| Total Living Sq Ft | 4,660 |
| Total Covered Sq Ft | 6,896 |
| Dimensions (w x d x h) | 120'0" x 98'6" x 29'9" |

| | First Floor | Other Floors | Other Features |
|------------------------|-------------|--------------|----------------------------------|
| Square Footage | 4,286 | 374 | Cabana Bath Outdoor Kitchen |
| Bedrooms | 4 | 0 | Computer AlcovePlayroom |
| Ceiling Heights | 12'0" | 9'0" | Corner Lot Unfinished Storage |
| Master Bedroom | X | | Covered Pavilion Vault Room |
| Dining Room | X | | Covered Rear Porch |
| Family Room | X | | Covered Side Porch |
| Game Room | | X | Foyer |
| Study | X | | Gallery |
| Guest Room | X | | Home Office |
| | | | Master with Sitting Area |
| | | | Mud Entry |

| | |
|------------------|-----------------------|
| Garage(s) | Side Load Straight In |
| Stairs | Standard |

The Roper 4660: Front Elevation



The Roper 4660: Floor 1

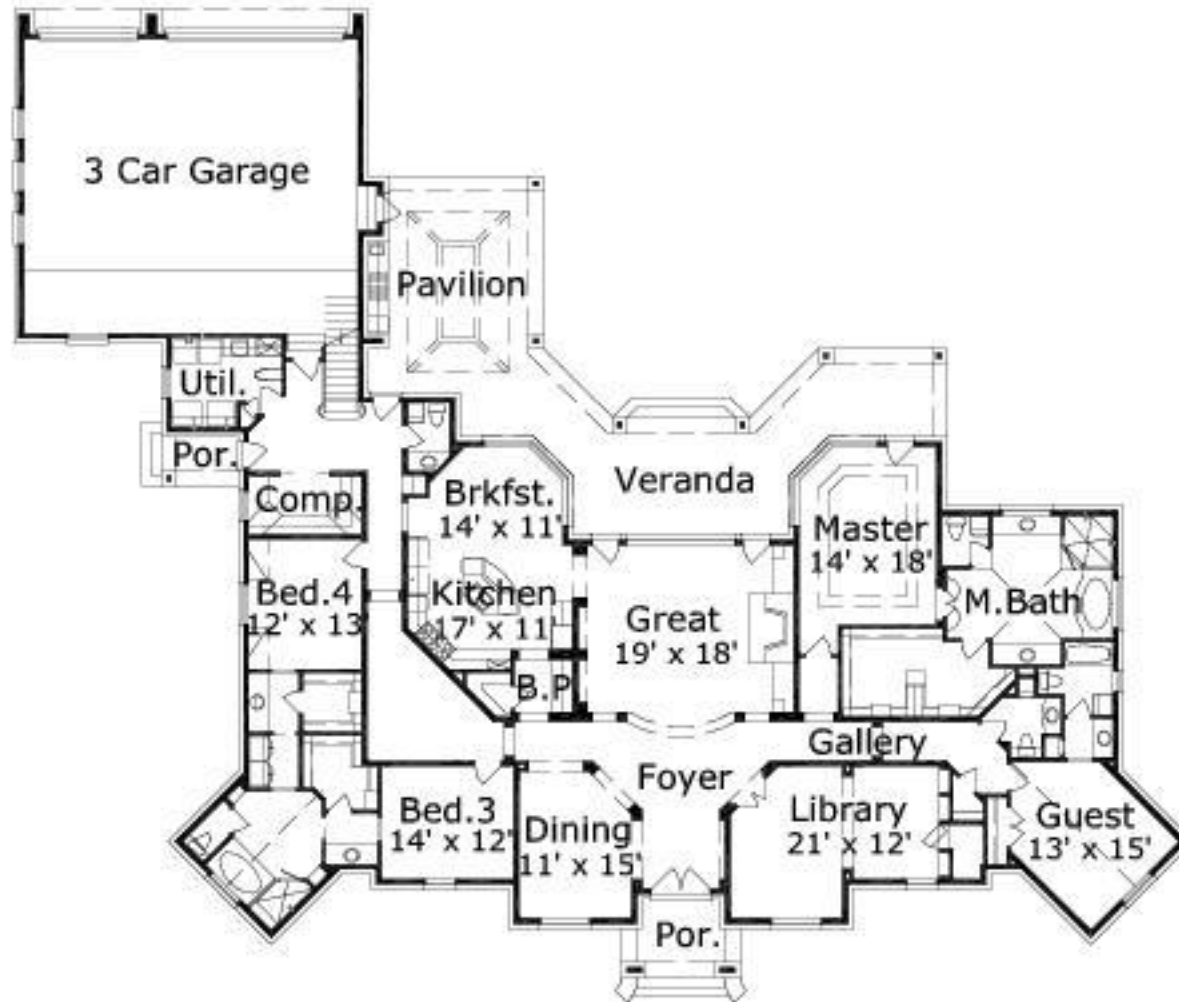

The Roper 4660: Floor 2

